

**DEPARTMENT OF NATURAL RESOURCES  
AND CONSERVATION**

**Northwestern Land Office - Plains Unit**

STEVE BULLOCK, GOVERNOR

14 AIRPORT RD



**STATE OF MONTANA**

PHONE: (406) 826-3851  
FAX: (406) 826-5785

P.O. BOX 219  
PLAINS, MT 59859

# The Montana Department of Natural Resources and Conservation Requests Input for a Proposed Road Easement

## PUBLIC NOTICE

The Montana Department of Natural Resources and Conservation, Plains Unit, is considering an easement request. Roger Bergmann has applied for easement on an existing road through State Lands in Section 36, T26N, R28W, a Common Schools Trust (CS), approximately 36 air miles northwest of Plains, Montana. The easement would provide access to 200 acres of privately owned land in Section 1, T25N, R28W for a single-family residence. The project may involve the construction of approximately 600 feet of new road construction on State lands.

We are evaluating and identifying environmental and social concerns. We are asking your assistance in this process by letting us know issues or concerns you may have with regard in the area. To ensure your comments are included in the planning process, please submit them to the Plains office by Friday, May 26, 2017.

Please direct oral or written comments to:  
Montana Department of Natural Resources and Conservation  
PO Box 219  
Plains, Montana 59859  
Attn: David Olsen  
(406) 826-4724  
E-mail: [dolsen@mt.gov](mailto:dolsen@mt.gov)

# Bergmann Easement S36, T26N, R28W Access to Pvt S1, T25N, R28W

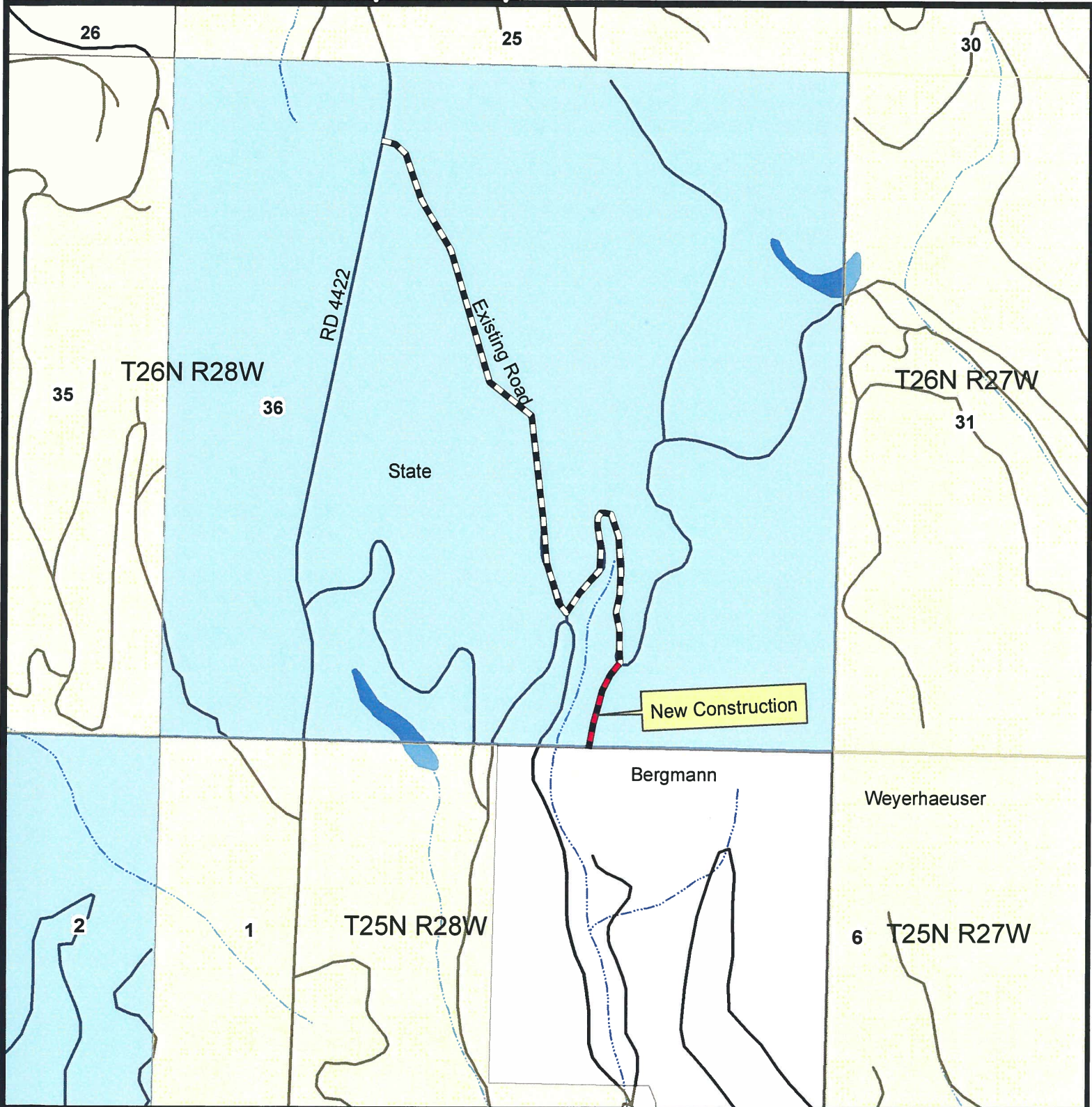

**Legend**

**Ownership - General Ownership**

- MT DNRC
- Weyerhaeuser

Montana DNRC  
Northwestern Land Office  
Timber





BERGMANN EASEMENT VICINITY MAP  
S36 T26N, R28W

A-1: Vicinity Map

