

Montana Department of Natural Resources and Conservation  
Water Resources Division  
Water Rights Bureau

**ENVIRONMENTAL ASSESSMENT**  
**For Routine Actions with Limited Environmental Impact**

**Part I. Proposed Action Description**

1. **Applicant/Contact name and address:**

Ross and Francine Nissen  
205 Siderius Ln  
Bigfork, MT 59911

2. **Type of action:** Surface Water Application for Beneficial Water Use Permit 76LJ 30117321

3. **Water source name:** Flathead River

4. **Location affected by project:** The place of use is located on Lot 26, Mayport Harbor, NWNWNW, Section 26, Township 27N, Range 20W, Flathead County, Montana.

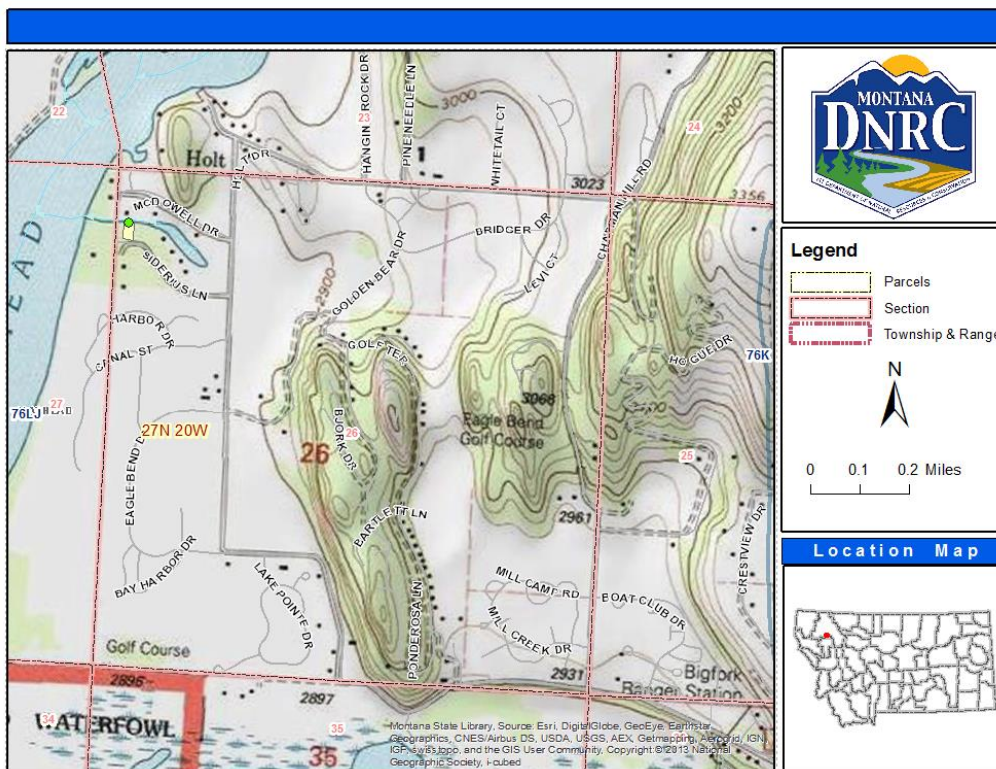

5. **Narrative summary of the proposed project, purpose, action to be taken, and benefits:**

The Applicant proposes to divert water from the Flathead River, by means of a pump, from April 15<sup>th</sup> – October 15<sup>th</sup> at 23 GPM up to 0.63 AF, from a point in Lot 26, Mayport Harbor, NWNWNW, Section 26, Township 27N, Range 20W, Flathead County, Montana to irrigate 0.25 acres of lawn and garden. The DNRC shall issue a water use permit if an Applicant proves the criteria in 85-2-311 MCA are met.

6. **Agencies consulted during preparation of the Environmental Assessment: (include agencies with overlapping jurisdiction)**

- U.S. Fish and Wildlife Service and Montana Natural Heritage Program: Endangered, Threatened Species and Species of Special Concern, Wetland Mapper program
- Montana Department of Fish Wildlife & Parks (DFWP); Dewatered Stream Information
- Montana Department of Environmental Quality's (MDEQ) Clean Water Act Information and PWS Drinking Water Watch databases
- U.S. Natural Resource Conservation Service (NRCS); web soil survey
- Montana Historical Society

**Part II. Environmental Review**

1. **Environmental Impact Checklist:**

<b>PHYSICAL ENVIRONMENT</b>
-----------------------------

**WATER QUANTITY, QUALITY AND DISTRIBUTION**

**Water quantity** - Assess whether the source of supply is identified as a chronically or periodically dewatered stream by DFWP. Assess whether the proposed use will worsen the already dewatered condition.

The Applicant proposes to divert water from the Flathead River, which is not listed by DFWP as chronically or periodically dewatered.

*Determination:* No impact.

**Water quality** - Assess whether the stream is listed as water quality impaired or threatened by DEQ, and whether the proposed project will affect water quality.

According to the Montana Department of Environmental Quality's (MDEQ) Clean Water Act Information Center in 2018 the Flathead River was categorized as having insufficient data to assess any use.

*Determination:* No impact.

**Groundwater** - Assess if the proposed project impacts ground water quality or supply.  
*If this is a groundwater appropriation, assess if it could impact adjacent surface water flows.*

This application is for surface water. A maximum of 30% of the diverted volume used for lawn and garden will return to groundwater and/or the original source.

*Determination:* No impact.

**DIVERSION WORKS** - Assess whether the means of diversion, construction and operation of the appropriation works of the proposed project will impact any of the following: channel impacts, flow modifications, barriers, riparian areas, dams, well construction.

The Applicant proposes to pump water from the Mayport Harbor commons area, which is a dredged harbor connected to the Flathead River, at a rate of 23 GPM via a 1HP Flotec FP5162 pump. The pump will sit on shore and divert water from the River thru a six foot 2-inch pipe. Water will be distributed to five irrigation zones. The number of sprinklers and output of each zone will vary. Hunter spray and rotor sprinklers will be used. One irrigation zone will operate at once; the largest zone requires 19 GPM. Pump specifications were included in the application. Based on the total dynamic head and pump curve associated with the pump; the system is capable of producing and distributing the requested flow rate and volume. 23 GPM is required to produce the required pressure for the largest zone. The proposed project shall not impact any channels, barriers, riparian areas and dams.

*Determination:* No impact.

### **UNIQUE, ENDANGERED, FRAGILE OR LIMITED ENVIRONMENTAL RESOURCES**

**Endangered and threatened species** - Assess whether the proposed project will impact any threatened or endangered fish, wildlife, plants or aquatic species or any "species of special concern," or create a barrier to the migration or movement of fish or wildlife. For groundwater, assess whether the proposed project, including impacts on adjacent surface flows, would impact any threatened or endangered species or "species of special concern."

The Montana Natural Heritage Program and DFWP websites were reviewed to determine if there are any threatened or endangered fish, wildlife, plants or aquatic species or any "species of special concern", that could be impacted by the proposed project.

According to the Montana Natural Heritage Program in Township 27N, Range 20W there are four plant species of concern: Crested Shieldfern (*Dryopteris cristata*), Beck Water-marigold (*Bidens beckii*), Watershield (*Brasenia schreberi*), and Giant Helleborine (*Epipactis gigantea*). Development has existed for over 30 years in this location, impact to sensitive plant species has most likely already occurred.

The Bull Trout (*Salvelinus confluentus*) is listed as threatened and the Westslope Cuthroat Trout (*Oncorhynchus clarkii lewisi*) is listed as sensitive by the USFS. The following are species of concern for the state of Montana: Hoary Bat (*Lasiurus cinereus*), Little Brown Myotis (*Myotis lucifugus*), Great Blue Heron (*Ardea herodias*), Brown Creeper (*Certhia americana*), Evening Grosbeak (*Coccothraustes vespertinus*), Pileated Woodpecker (*Dryocopus pileatus*), Cassin's

Finch (*Haemorhous cassinii*) and Common Tern (*Sterna hirundo*). An adequate quantity of water will still exist in surface water sources to maintain existing populations of Bull Trout and Westslope Cutthroat trout should they exist there currently. Development has existed on this section of land for 30 plus years; any impacts to sensitive mammal species most likely has already occurred. No impact.

*Determination:* No impact.

**Wetlands** - *Consult and assess whether the apparent wetland is a functional wetland (according to COE definitions), and whether the wetland resource would be impacted.*

*Determination:* N/A, project does not involve wetlands or critical riparian habitats

**Ponds** - *For ponds, consult and assess whether existing wildlife, waterfowl, or fisheries resources would be impacted.*

*Determination:* N/A, project does not involve ponds.

**GEOLOGY/SOIL QUALITY, STABILITY AND MOISTURE** - *Assess whether there will be degradation of soil quality, alteration of soil stability, or moisture content. Assess whether the soils are heavy in salts that could cause saline seep.*

Per soil survey data provided by the NRCS, soil within the place of use consists mostly of silt loam, which are well drained soils. Soils within the place of use are slightly susceptible to saline seep. The stability of the soil profile and moisture content will not be significantly altered. No degradation of soil quality shall occur.

*Determination:* No impact.

**VEGETATION COVER, QUANTITY AND QUALITY/NOXIOUS WEEDS** - *Assess impacts to existing vegetative cover. Assess whether the proposed project would result in the establishment or spread of noxious weeds.*

Any impacts to existing vegetation will be within the range of current disturbances due to current land use practices. Noxious weeds are not expected to be established or spread.

*Determination:* No impact.

**AIR QUALITY** - *Assess whether there will be a deterioration of air quality or adverse effects on vegetation due to increased air pollutants.*

Adverse air quality impacts from increased air pollutants are not expected as a result of this project. No air pollutants were identified as resulting from the applicants proposed use.

*Determination:* No impact.

**HISTORICAL AND ARCHEOLOGICAL SITES** - *Assess whether there will be degradation of unique archeological or historical sites in the vicinity of the proposed project if it is on State or Federal*

*Lands. If it is not on State or Federal Lands simply state NA-project not located on State or Federal Lands.*

*Determination: N/A, project is not located on state or federal land.*

**DEMANDS ON ENVIRONMENTAL RESOURCES OF LAND, WATER, AND ENERGY** - *Assess any other impacts on environmental resources of land, water and energy not already addressed.*

All impacts to land, water and energy have been identified and no further impacts are anticipated.

*Determination: No impact.*

## **HUMAN ENVIRONMENT**

**LOCALLY ADOPTED ENVIRONMENTAL PLANS AND GOALS** - *Assess whether the proposed project is inconsistent with any locally adopted environmental plans and goals.*

The project is located in an area with no locally adopted environmental plans.

*Determination: No impact.*

**ACCESS TO AND QUALITY OF RECREATIONAL AND WILDERNESS ACTIVITIES** - *Assess whether the proposed project will impact access to or the quality of recreational and wilderness activities.*

The proposed project will not inhibit, alter or impair access to present recreational opportunities in the area. The project is not expected to create any significant pollution, noise, or traffic congestion in the area that may alter the quality of recreational opportunities. The proposed place of use and diversion do not exist on land designated as wilderness.

*Determination: No impact.*

**HUMAN HEALTH** - *Assess whether the proposed project impacts on human health.*

There should be no significant negative impact on human health from this proposed use.

*Determination: No impact.*

**PRIVATE PROPERTY** - *Assess whether there are any government regulatory impacts on private property rights.*

*Yes \_\_\_ No x \_\_\_ If yes, analyze any alternatives considered that could reduce, minimize, or eliminate the regulation of private property rights.*

*Determination: No impact.*

**OTHER HUMAN ENVIRONMENTAL ISSUES** - For routine actions of limited environmental impact, the following may be addressed in a checklist fashion.

*Impacts on:*

- (a) Cultural uniqueness and diversity? None identified.
- (b) Local and state tax base and tax revenues? None identified.
- (c) Existing land uses? None identified.
- (d) Quantity and distribution of employment? None identified.
- (e) Distribution and density of population and housing? None identified.
- (f) Demands for government services? None identified.
- (g) Industrial and commercial activity? None identified.
- (h) Utilities? None identified.
- (i) Transportation? None identified.
- (j) Safety? None identified.
- (k) Other appropriate social and economic circumstances? None identified.

**2. Secondary and cumulative impacts on the physical environment and human population:**

Secondary Impacts: None identified.

Cumulative Impacts: None identified.

**3. Describe any mitigation/stipulation measures:** None identified.

**4. Description and analysis of reasonable alternatives to the proposed action, including the no action alternative, if an alternative is reasonably available and prudent to consider:** No reasonable alternatives were identified in the EA.

**PART III. Conclusion**

**1. Preferred Alternative:** None identified.

**2. Comments and Responses:** None.

**3. Finding:**

Yes\_\_\_ No **x**\_\_\_ Based on the significance criteria evaluated in this EA, is an EIS required?

***If an EIS is not required, explain why the EA is the appropriate level of analysis for this proposed action:***

An EA is the appropriate level of analysis for the proposed action because no significant impacts were identified.

***Name of person(s) responsible for preparation of EA:***

*Name:* Melissa Brickl

*Title:* Hydrologist/Water Resource Specialist

*Date:* September 17, 2018