

## NOTICE OF SALE

### Department of Natural Resources & Conservation Timber Sale

The King/Bear Timber Sale is located within Sections 20, 29, and 30, T32N-R22W, on the State's Stillwater Unit. Approximately 3,473 tons, consisting of Douglas-fir, western larch, Engelmann spruce, lodgepole pine, grand fir, and western white pine are offered for sale.

Sealed bids will be opened at the Department of Natural Resources & Conservation, 2705 Spurgin Road, Missoula, Montana on **March 27, 2006 at 2:00 p.m.** Bids may be hand delivered or mailed and will be accepted any time prior to the bid opening. **DNRC recommends that bidders contact the Trust Land Management Division (406-542-4300) prior to the bid opening to ensure that your bid has been received.** Bids must be accompanied by a deposit of **\$5,383.00** representing 5% of the minimum bid of the sale in cashier's check, certified check, bank money order or bank draft to be applied to the stumpage for the successful bidder. Bid bonds will be accepted and, for the successful bidder, will be closed upon execution of the Timber Sale Contract and Timber Sale Bond.

The sale will be awarded to the highest responsible bidder. If the successful bidder is unable to execute the contract within 45 calendar days from the date the sale is awarded, the bid deposit will be retained by the Department as liquidated damages. The right is reserved to reject any or all bids.

Prospective bidders can obtain the sale prospectus, sale contract and bid forms from the Department of Natural Resources & Conservation, Trust Land Management Division, in Missoula (406-542-4300), the Northwest Land Office in Kalispell, or the Stillwater Unit office in Olney, MT (406-881-2371).

Visit our website at <http://www.dnrc.mt.gov/trust/fmb.htm> for upcoming sales and bid results

/s/ David A. Groeschl, Chief  
Forest Management Bureau  
Trust Land Mgmt Division

Publication Dates: February 23, March 2, 9, 16, 2006

**TIMBER SALE PROSPECTUS**  
**MONTANA DEPARTMENT OF NATURAL RESOURCES AND CONSERVATION**

<b>Timber Sale Name:</b> King Bear			
<b>Timber Sale Location:</b> Sections 20, 29, and 32, T32N-R22W			
<b>For specific sale information, contact:</b> Pete Evans or Mike McMahon			
Phone	406-881-2675 or 881-2670	Stillwater	Unit Office
<b>For copies of the Timber Sale Contract and bid forms, contact:</b>			
Phone	406-542-4300	Forest Management Bureau	DNRC Missoula Office
Phone	406-751-2240	Northwestern Land Office	

**General Bidding Information**

1. Bids must be submitted on standard DNRC bid forms.
2. Timber will be sold to the highest responsible bidder; however, the Department reserves the right to reject any or all bids.
3. DNRC recommends that bidders contact the Forest Management Bureau, Trust Land Management Division (406-542-4300) prior to the bid opening to ensure that your bid has been received.
4. A **bid guarantee** must accompany all bids and must be in the form of cash, cashiers check, certified check, bank money order, bank draft, surety bond or irrevocable letter of credit.
5. The Purchaser must submit a **performance bond** within 45 days of the sale award. It will amount to 20% or more of the bid value of the sale. The performance bond may be in the form of cash, irrevocable letter of credit, surety bond or certificate of deposit. The performance bond must be maintained separately from other payments for the duration of the sale contract.
6. The purchaser must submit an **advance stumpage payment** prior to cutting any timber. The amount of the advance will be based on the expected harvest rate and the bid value of the stumpage. The advance may be in the form of cash, irrevocable letter of credit, payment bond or certificate of deposit.
7. The purchaser will pay **Forest Improvement fees** and any special **Road Use and Maintenance fees** in addition to stumpage payments.
8. The successful bidder must sign an agreement that prohibits exporting State logs.
9. This sale is being sold based on the gross weight of all species. Minimum price and bid price is per ton. The price is for all species, green and dead. Billing will be based on gross weight. A weight ticket from a certified scale is required for every load.
10. The Department has estimated the net scale merchantable sawlog volume to be available for purchase under this contract. All delivered wood will be weighed and billed at per ton bid rates. The Department recognizes that a percentage of delivered wood may not meet the log manufacturing and recovery standards of the timber sale contract. The actual percentage will vary based on the log manufacturing and recovery specifications of the purchaser and the tree conditions in the sale area. The actual delivered weight may vary, resulting in an overrun or under-run of the estimated tonnage. DNRC strongly recommends that bidders evaluate these effects before bidding.
11. DNRC does not conduct detailed road appraisals. All appraised costs are gross estimates or averages, provided only to show the relative amount of work required, and not its market value. Purchasers should make their own estimates based on contract requirements.
12. Bidders should examine the Timber Sale Contract and sale area prior to bidding. Additional information is available at the phone numbers shown above.
13. Estimated stand data in this prospectus and volume estimates in the sale contract are not guaranteed.
14. This prospectus is provided for information purposes only. If the prospectus is in error or contradicts the Timber Sale Contract, the contract governs.

**TABLE 1: Summary of Sale Specifications**

Sale Data			
42	Net Sale Area (acres)	None	Miles of road construction
August 1, 2007	Contract ending date	1.5	Miles of road reconstruction
None	Cable logging required (% of volume)	None	Miles of road reclamation or abandonment
Operating Season:	When soil compaction restrictions can be met		
Charges and Appraised Costs			
\$ 5,383.00	Bid Guarantee (total \$)		
20% of bid value	Performance Bond		
\$ N/A	Collected Road Maintenance And Road Use Charges (\$ per ton)		
\$ 3.24	Collected Forest Improvement Fee (\$ per ton) (concurrent with stumpage payments)		
\$ N/A	Quarterly Installment of Forest Improvement Payments		
\$ 17,045.00	Road Development Costs - Appraised Purchaser-Do (total \$)		
\$ 1.64	Road Maintenance Costs - Appraised Purchaser-Do (\$ per ton)		
\$ None	Slash Disposal Costs - Appraised Purchaser-Do (\$ per ton)		
\$ 0.12	Timber Stand Improvement Costs - Appraised Purchaser-Do (\$ per ton)		

**TABLE 2: Timber Cruise Data and Minimum Bids**

SPECIES	GF	DF	WL	LP	ES	SAF		WWP	TOTAL or AVE
Minimum Acceptable Bid									\$31.00/ton
Gross Cubic Feet (in thousands)	25.3	42.4	44	3.1	6.4	9.9		3.1	134.2
% Cull and Breakage	22.0	10.1	9.5	6.1	10.9	10.3		42	
Net Cubic Feet (in thousands)	19.7	38.1	39.8	2.9	5.7	8.9		1.8	116.9
Pounds per cubic foot	60.0	61.7	58.3	56.0	57.0	55.0		60.0	
Net tons	592	1175.9	1,161.0	81.5	162.5	244.2		55.9	3,473.0
Gross MBF (Scribner 6" top DIB)	118.5	199.4	240.8	15.0	31.4	40.8		15.6	661.5
% Cull and Breakage	22.2	10.1	9.5	6.1	10.9	10.3		42.0	
Net MBF	92.1	179.3	218.4	14.1	28.0	36.6		9.1	577.6
Average logs per MBF	19.1	17.5	12.4	18.1	16.5	29.6		14.5	16.7
Average DBH	12	12	15	9	14	9		14	11.25
Average tons per acre harvested in leave-tree marked units									77
Average tons per acre harvested in cut-tree-marked units									52.5
Average MBF to cut per acre on the timber sale									12.8
Range of cut trees per acre based on unit cruise									100 to 147
Calculated Sampling Error ( <i>net</i> MBF): 16.15%									
The total cruised volume will fall between 484.2 and 670 thousand net board feet in 9 out of 10 cruises.									
Tons Per Thousand Board Feet Conversion Factor = net tons 3,473 per 577.6 net MBF = 6.01 tons per MBF.									

<b>TABLE 3: Unit Harvest Volume and Harvest Schedule</b>					
Unit	Section	Acres	Estimated Net Tons	Estimated Net MBF	Removal Date
1	29, 32	19	2,198	365.7	March 15, 2007
2	20	21	1,170	194.7	March 15, 2007
3	29	2	105	17.5	March 15, 2007

**Additional Sale Information:**

1. A gate at King Creek Road restricts public access. Arrangements must be made to obtain a key at the Stillwater Unit Office in Olney.
2. **During the winter, access to the sale is best made by snowmobile. Please contact the Stillwater Unit (406-881-2371) for parking locations and other specifics.**
3. The designated haul route is via Lower Whitefish Road and Upper Whitefish Road to Highway 93 at Olney.
4. No trucks utilized for hauling logs or equipment will access or leave the sale area on the East Lakeshore or DelRey roads.
5. Unit 2 has the following requirement: The Purchaser will slash all non-merchantable material, including leaners and pushovers, taller than 2 feet after harvesting operations in this unit are completed and approved; cull trees and snags do not have to be slashed. Stems shall be completely severed from the stumps. Stumps shall not exceed 8 inches in height on the uphill side. Slashed material must be felled directionally to remain within the harvest unit.
6. The Forest Improvement fee for this sale is \$3.24 per ton. Payments will be made concurrently with stumpage payments.

**TABLE 4: Total Net Board Feet (6" top diameter) by Diameter Class and Species (Cut trees)**

DBH Class	Thousand Board Feet								TOTAL
	GF	DF	WL	LP	ES	SAF	WRC		
≥7 and < 9	2	1	0	0	0	4		0	7
≥9 and < 11	9	14	2	0	3	16		2	46
≥11 and < 13	22	18	10	8	7	13		0	78
≥13 and < 15	12	38	9	0	4	3		4	70
≥15 and < 17	22	27	33	6	0			0	88
≥17 and < 19	16	31	48		6			1	102
≥19 and < 21	9	32	46		8			0	95
≥21 and < 23	0	14	41					2	57
≥23 and < 25	1	2	16					0	19
≥25 and < 27	0	3	13						16
≥27 and < 29									
<b>TOTAL</b>	<b>93</b>	<b>180</b>	<b>218</b>	<b>14</b>	<b>28</b>	<b>36</b>		<b>9</b>	<b>578</b>

**TABLE 5: Total Tons of Cut Trees by Diameter Class and Species**

DBH Class	GF	DF	WL	LP	ES	SAF	WRC		TOTAL
≥7 and < 9	19	11	0	0	0	34		0	64
≥9 and < 11	65	115	14	0	18	110		13	335
≥11 and < 13	154	125	63	53	44	81		0	520
≥13 and < 15	75	259	58	0	21	18		24	455
≥15 and < 17	128	176	183	29	0			0	516
≥17 and < 19	94	190	261		36			7	588
≥19 and < 21	50	189	235		44			0	518
≥21 and < 23	0	80	206		0			12	298
≥23 and < 25	7	15	76		0			0	98
≥25 and < 27	0	16	65		0			0	81
≥27 and < 29									
<b>TOTAL</b>	<b>592</b>	<b>1,176</b>	<b>1,161</b>	<b>82</b>	<b>163</b>	<b>243</b>		<b>56</b>	<b>3,473</b>

# King/Bear Timber Sale Road Map



Attachment A  
Page 3 of 3

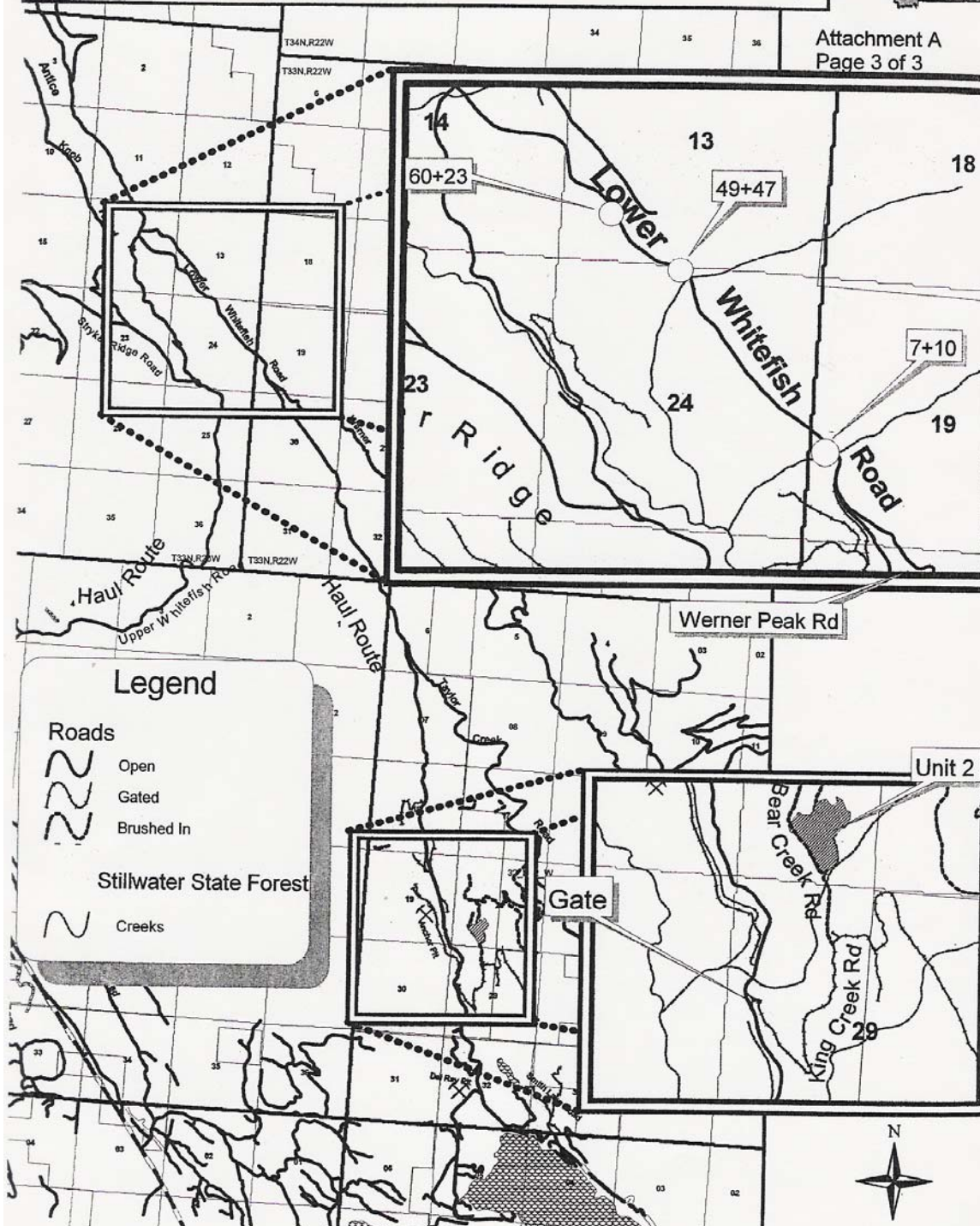



# King/Bear Timber Sale Unit Map

Sections 20,29,and 32 ,T32N, R22W

Attachment A  
Page 2 of 3

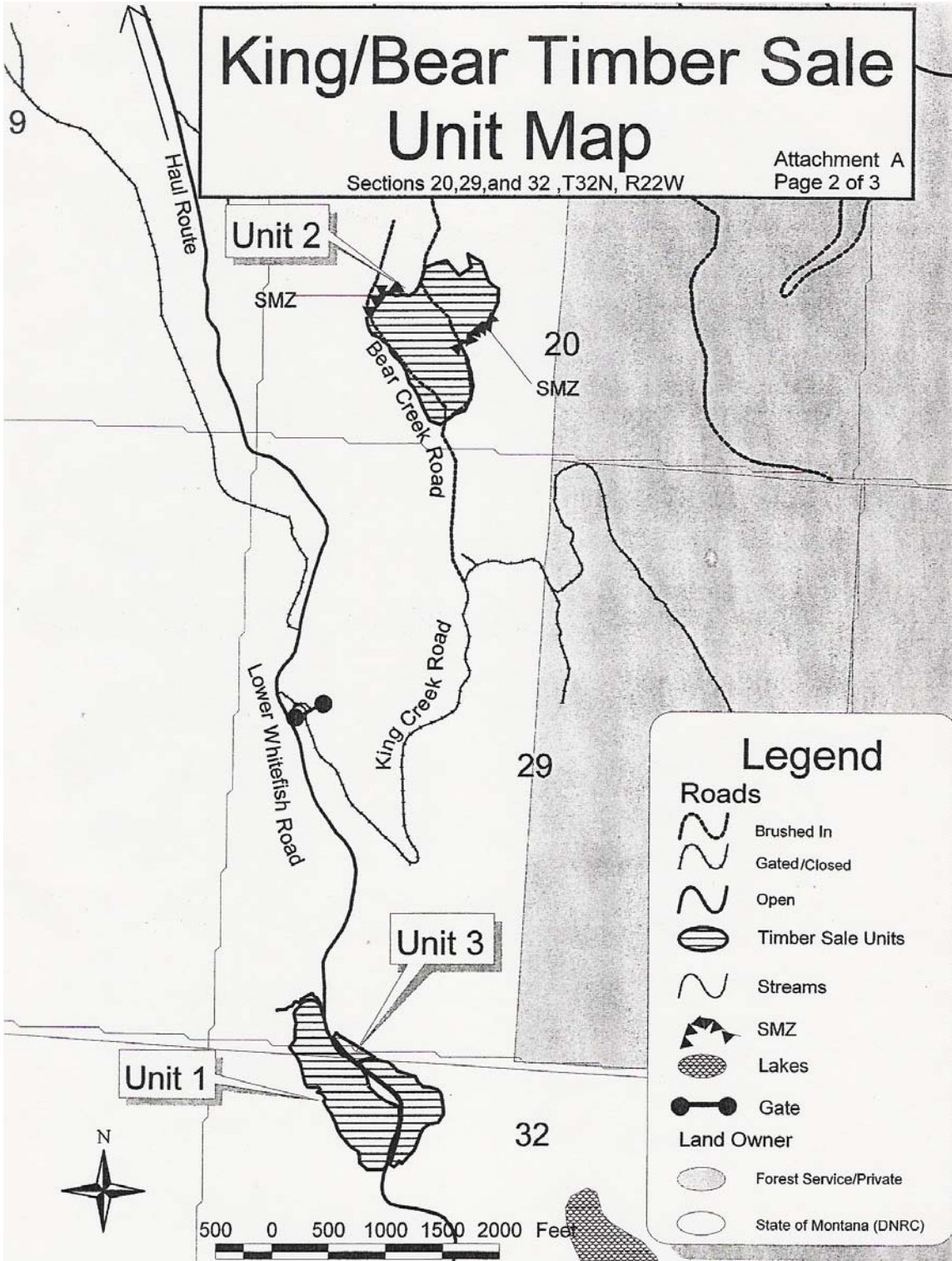

# King /Bear Timber Sale Vicinity Map

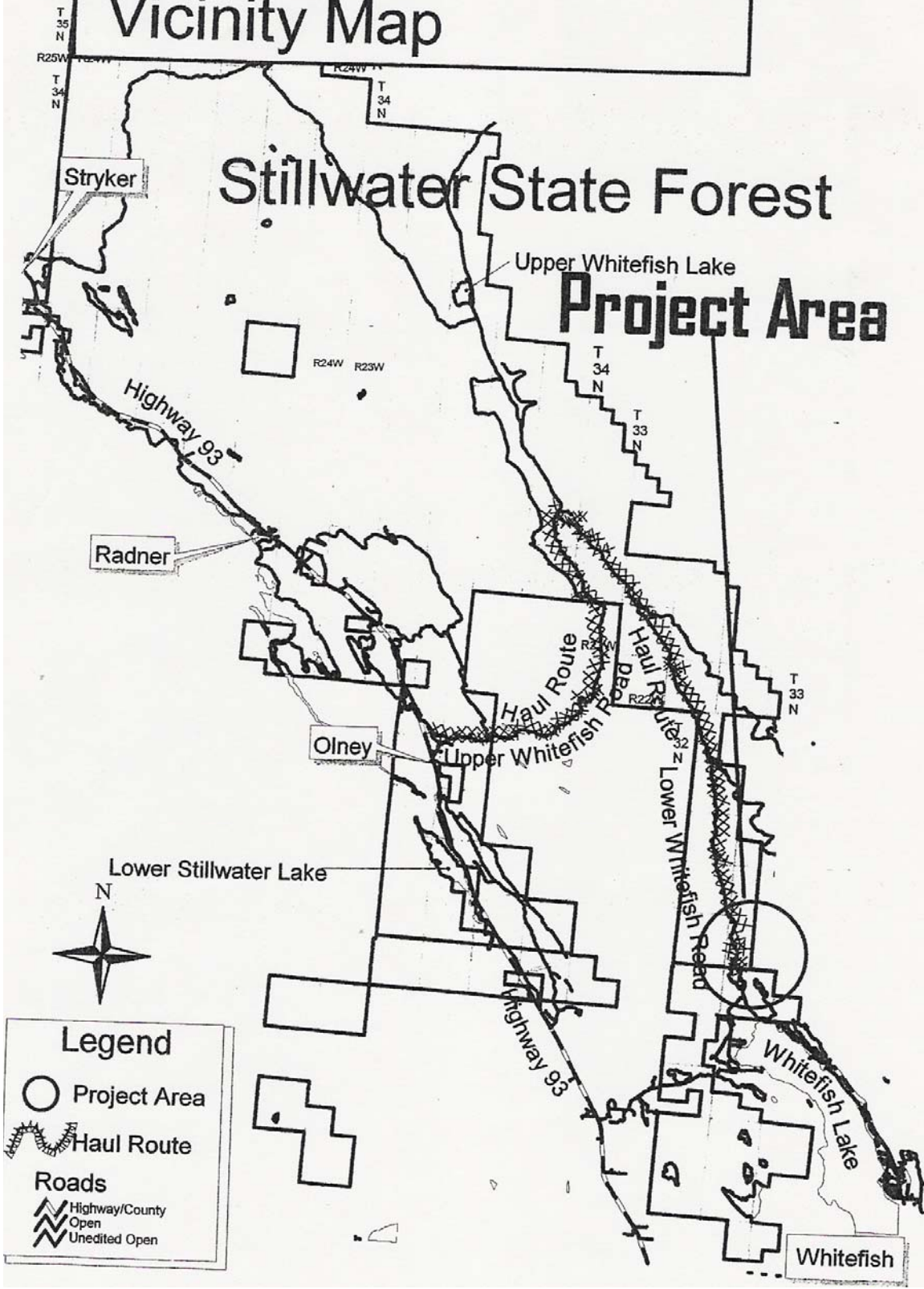

**Legend**

- Project Area
- ⋈ Haul Route
- Roads**
  - ⋈ Highway/County
  - ⋈ Open
  - ⋈ Unedited Open