

NOTICE OF SALE

Department of Natural Resources & Conservation Timber Sale

The Ewing Middle Ridge Timber Sale is located within Sections 11, 12, 13, and 14, T33N-R24W, and Section 18, T33N-R23W, on the State's Stillwater Unit. Approximately 8,568 tons, consisting of Douglas-fir, grand fir, lodgepole pine, Engelmann spruce, western larch, and western red cedar sawlogs are offered for sale.

Sealed bids will be opened at the Department of Natural Resources and Conservation, 2705 Spurgin Road, Missoula, Montana on **March 20, 2006 at 2:00 p.m.** Bids may be hand delivered or mailed and will be accepted any time prior to the bid opening. **DNRC recommends that bidders contact the Trust Land Management Division (406-542-4300) prior to the bid opening to ensure that your bid has been received.** Bids must be accompanied by a deposit of **\$9,768.00** representing 5% of the minimum bid value of the sale in cashier's check, certified check, bank money order or bank draft to be applied to the stumpage for the successful bidder. Bid bonds will be accepted and, for the successful bidder, will be closed upon execution of the Timber Sale Contract and Timber Sale Bond.

The sale will be awarded to the highest responsible bidder. If the successful bidder is unable to execute the contract within 45 calendar days from the date the sale is awarded, the bid deposit will be retained by the Department as liquidated damages. The right is reserved to reject any or all bids.

Prospective bidders can obtain the sale prospectus, sale contract and bid forms from the Department of Natural Resources & Conservation, Trust Land Management Division, in Missoula (406-542-4300), the Northwestern Land Office in Kalispell (406-751-2240), or the Stillwater Unit Office in Olney, MT (406-881-2371).

Visit our website at <http://dnrc.mt.gov/trust/FMB> for upcoming sales and bid results.

/s/ David A. Groeschl, Chief
Forest Management Bureau
Trust Land Mgmt Division

Publication Dates: February 16, 23, March 2, 9, 2006

TIMBER SALE PROSPECTUS
MONTANA DEPARTMENT OF NATURAL RESOURCES AND CONSERVATION

Timber Sale Name: Ewing Middle Ridge			
Timber Sale Location: Sections 11, 12, 13, and 14, T33N-R24W, and Section 18, T33N-R23W			
For specific sale information, contact: Nicole Stickney or Brian Manning			
Phone	406-881-2371	Stillwater Unit Office	
For copies of the Timber Sale Contract and bid forms, contact:			
Phone	406-542-4300	Forest Management Bureau	DNRC Missoula Office
Phone	406-751-2240	Northwestern Land Office	

General Bidding Information

1. Bids must be submitted on standard DNRC bid forms.
2. Timber will be sold to the highest responsible bidder; however, the Department reserves the right to reject any or all bids.
3. DNRC recommends that bidders contact the Forest Management Bureau, Trust Land Management Division (406-542-4300) prior to the bid opening to ensure that your bid has been received.
4. A **bid guarantee** must accompany all bids and must be in the form of cash, cashiers check, certified check, bank money order, bank draft, surety bond or irrevocable letter of credit.
5. The Purchaser must submit a **performance bond** within 45 days of the sale award. It will amount to 20% or more of the bid value of the sale. The performance bond may be in the form of cash, irrevocable letter of credit, surety bond or certificate of deposit. The performance bond must be maintained separately from other payments for the duration of the sale contract.
6. The purchaser must submit an **advance stumpage payment** prior to cutting any timber. The amount of the advance will be based on the expected harvest rate and the bid value of the stumpage. The advance may be in the form of cash, irrevocable letter of credit, payment bond or certificate of deposit.
7. The purchaser will pay **Forest Improvement fees** and any special **Road Use and Maintenance fees** in addition to stumpage payments.
8. The successful bidder must sign an agreement that prohibits exporting State logs.
9. This sale is being sold based on the gross weight of all species. Minimum price and bid price is per ton. The price is for all species, green and dead. Billing will be based on gross weight. A weight ticket from a certified scale is required for every load.
10. The Department has estimated the net scale merchantable sawlog volume to be available for purchase under this contract. All delivered wood will be weighed and billed at per ton bid rates. The Department recognizes that a percentage of delivered wood may not meet the log manufacturing and recovery standards of the timber sale contract. The actual percentage will vary based on the log manufacturing and recovery specifications of the purchaser and the tree conditions in the sale area. The actual delivered weight may vary, resulting in an overrun or under-run of the estimated tonnage. DNRC strongly recommends that bidders evaluate these effects before bidding.
11. DNRC does not conduct detailed road appraisals. All appraised costs are gross estimates or averages, provided only to show the relative amount of work required, and not its market value. Purchasers should make their own estimates based on contract requirements.
12. Bidders should examine the Timber Sale Contract and sale area prior to bidding. Additional information is available at the phone numbers shown above.
13. Estimated stand data in this prospectus and volume estimates in the sale contract are not guaranteed.
14. This prospectus is provided for information purposes only. If the prospectus is in error or contradicts the Timber Sale Contract, the contract governs.

TABLE 1: Summary of Sale Specifications			
Sale Data			
126	Net Sale Area (acres)	None	Miles of road construction
July 31, 2008	Contract ending date	None	Miles of road reconstruction
84%	Cable logging required (% of volume)	7.15	Miles site improvements and BMPs
Operating Season: July 2006 – March 2008, depending on soil moisture.			
Charges and Appraised Costs			
\$9,768.00	Bid Guarantee (total \$)		
20% of bid value	Performance Bond		
\$ None	Collected Road Maintenance And Road Use Charges (\$ per ton)		
\$ 3.10	Collected Forest Improvement Fee (\$ per ton)		
\$ 4,426.80	Quarterly Installment of Forest Improvement Payments (\$ per payment, first 5 payments)		
\$ 42,244	Road Development Costs - Appraised Purchaser-Do (total \$)		
\$ 0.22	Road Maintenance Costs - Appraised Purchaser-Do (\$ per ton)		
\$ None	Slash Disposal Costs - Appraised Purchaser-Do (\$ per ton)		
\$ None	Timber Stand Improvement Costs - Appraised Purchaser-Do (\$ per ton)		

TABLE 2: Timber Cruise Data and Minimum Bids									
SPECIES	GF	DF	WL	LP	ES	SAF	WRC		TOTAL or AVE
Minimum Acceptable Bid									\$22.80/ton
Gross Cubic Feet (in thousands)	66	193	21	7	6	2	24		318
% Cull and Breakage	13.6	8.3	9.9	3.9	6.2	4.8	11.6		9.6
Net Cubic Feet (in thousands)	57	177	19	6	6	2	21		288
Pounds per cubic foot	60	62	58	56	55	55	44		60
Net tons	1,699	5,445	554	181	174	60	455		8,568
Gross MBF (Scribner 5.6" top DIB)	300	922	107	28	9	9	108		1,505
% Cull and Breakage	13.7	8.3	9.9	3.9	5.0	5.0	11.4		9.6
Net MBF	256	830	97	27	27	9	95		1,341
Average logs per MBF	19.8	15.2	16.0	29.1	26.8	26.8	20.3		17.0
Average DBH	12	15	13	9	11	11	12		13
Average tons per acre harvested in leave-tree marked units									68
Average tons per acre harvested in cut-tree-marked units									N/A
Average MBF to cut per acre on the timber sale									10.8
Range of cut trees per acre based on unit cruise									101-118
Calculated Sampling Error (<i>net</i> MBF): 15.17%									
The total cruised volume will fall between 1,155 and 1,567 thousand net board feet in 9 out of 10 cruises.									
Tons Per Thousand Board Feet Conversion Factor = 8,568 net tons per 1,341 net MBF = 6.39 tons per MBF.									

TABLE 3: Unit Harvest Volume and Harvest Schedule					
Unit	Section	Acres	Estimated Net Tons	Estimated Net MBF	Removal Date
1	11,12,13,14	111	7,195	1,114	March 15, 2008
2	13,18	15	1,373	227	March 15, 2008

Additional Sale Information:

1. A gate off the Middle Ewing Road restricts public access. Please make arrangements to obtain a key at the Stillwater Unit office in Olney for inspection of the sale area.
2. **During the winter, access to the sale area is best made by snowmobile. Please contact the Stillwater Unit (406-881-2371) for parking locations and other specifics.**

TABLE 4: Total Net Scribner in MBF (6" top diameter) by Diameter Class and Species (Cut trees)

DBH Class	Thousand Cubic Feet								TOTAL
	GF	DF	WL	LP	ES	SAF	WRC		
≥7 and < 9	3		0	0	3	0	4		10
≥9 and < 11	57	36	5	27	2	0	5		131
≥11 and < 13	38	78	12	0	0	9	22		157
≥13 and < 15	33	96	23	0	6	0	11		163
≥15 and < 17	41	159	5	0	8	0	11		226
≥17 and < 19	63	114	20	0	10	0	8		213
≥19 and < 21	11	163	21	0	0	0	8		189
≥21 and < 23	13	103	11	0	0	0	15		137
≥23 and < 25	0	59	0	0	0	0	7		63
≥25 and < 27	0	21	0	0	0	0	0		21
≥27 and < 29	0	0	0	0	0	0	0		0
29+	0	27	0	0	0	0	0		27
TOTAL	254	831	97	27	29	9	96		1,341

* Differences due to rounding

TABLE 5: Total Number of Cut Trees by Diameter Class and Species

DBH Class	GF	DF	WL	LP	ES	SAF	WRC		TOTAL
≥7 and < 9	404	0	187	474	143	0	318		1,426
≥9 and < 11	1,431	922	92	500	138	0	340		3,423
≥11 and < 13	620	1,270	152	0	0	185	324		2,551
≥13 and < 15	261	1,006	175	0	47	0	121		1,609
≥15 and < 17	272	1,085	36	0	41	0	80		1,512
≥17 and < 19	290	582	66	0	28	0	39		1,006
≥19 and < 21	59	559	51	0	0	0	28		697
≥21 and < 23	49	315	25	0	0	0	44		432
≥23 and < 25	0	146	0	0	0	0	16		162
≥25 and < 27	0	33	0	0	0	0	0		33
≥27 and < 29	0	0	0	0	0	0	0		0
29+	0	39	0	0	0	0	0		39
TOTAL	3,385	5,957	784	874	397	185	1,308		12,891

Ewing Middle Ridge Timber Sale Unit Map

ATTACHMENT A
pg 2 of 3

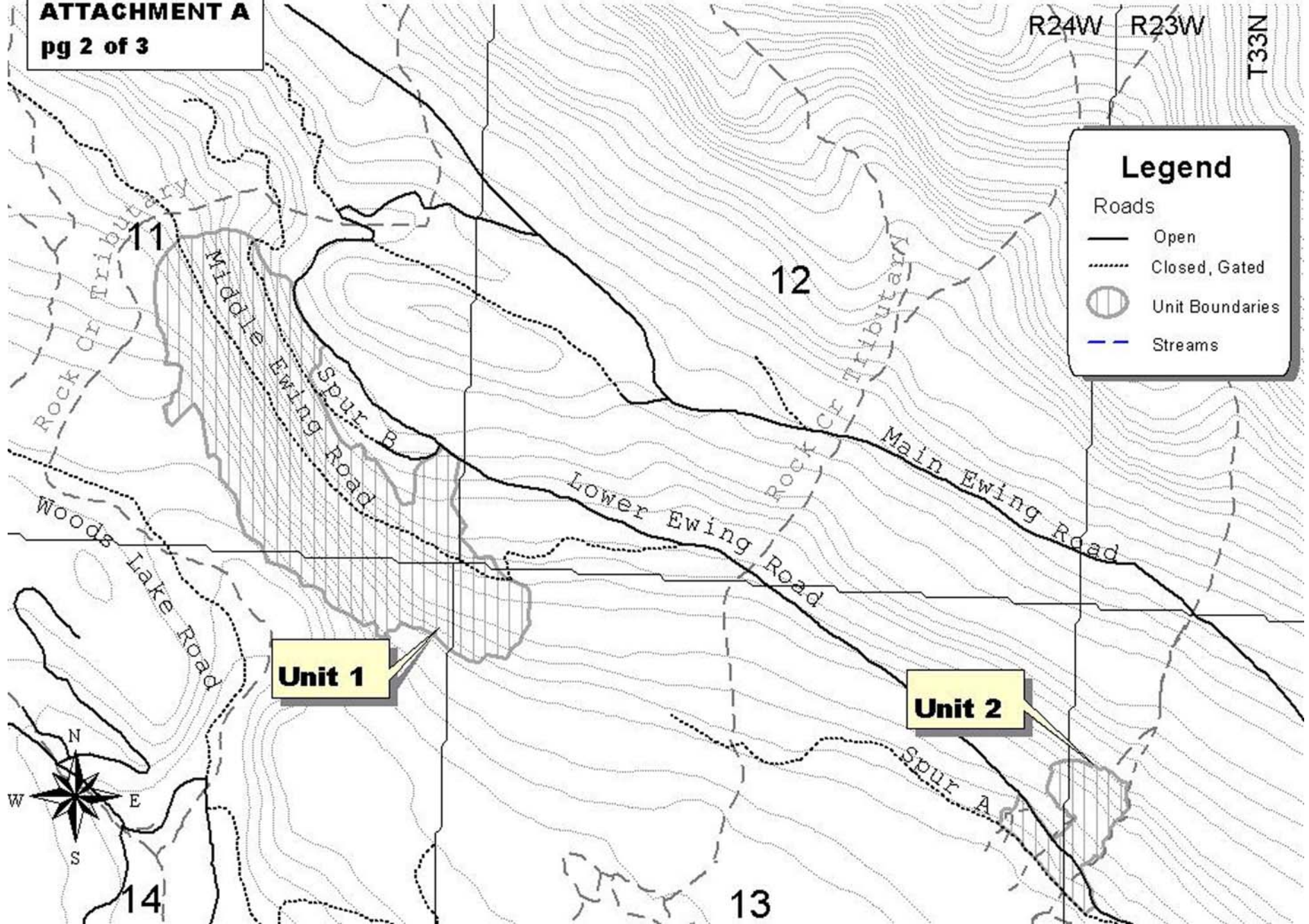

Ewing Middle Ridge Timber Sale Road Map

ATTACHMENT A
pg 3 of 3

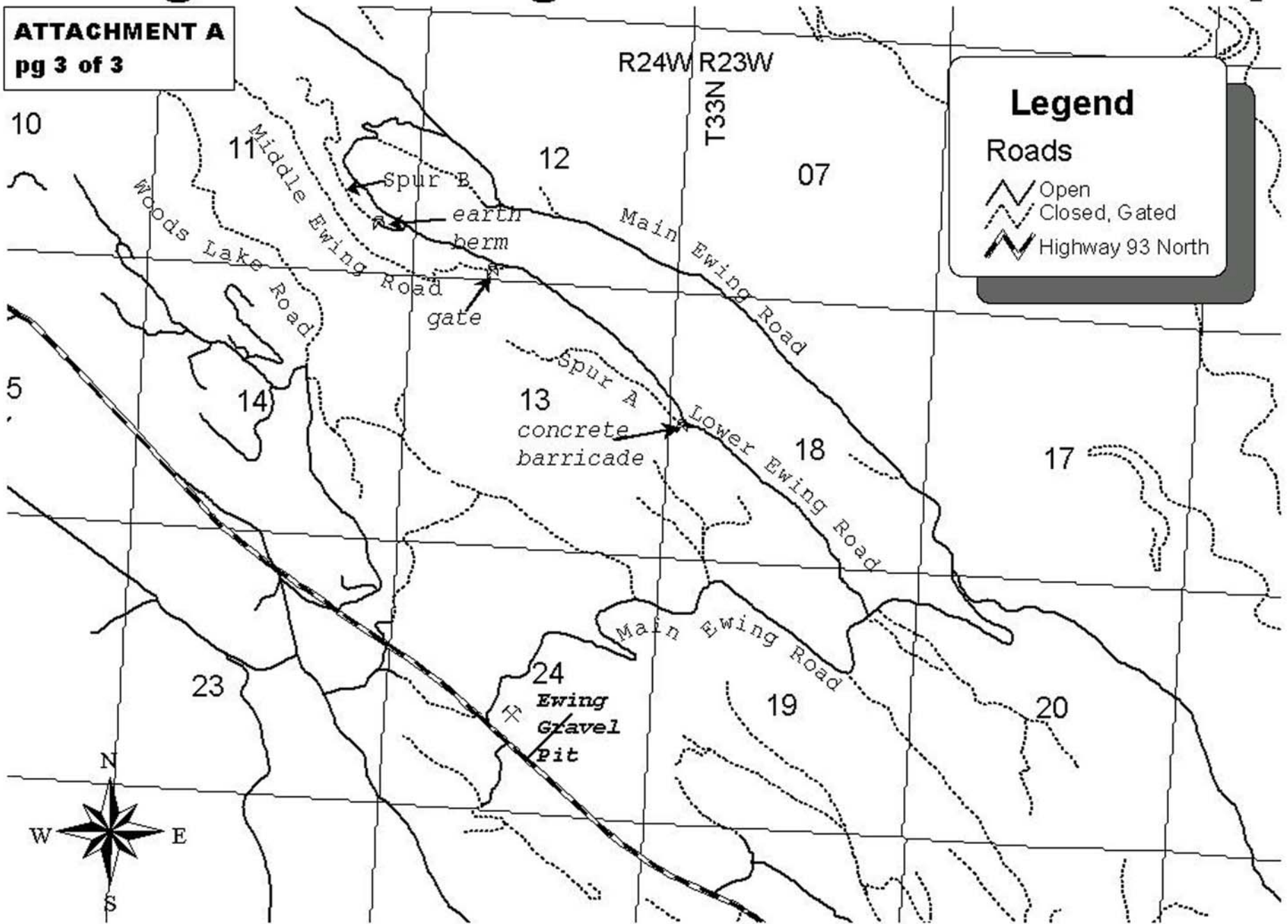

Vicinity Map for Ewing Middle Ridge Timber Sale

ATTACHMENT A

pg 1 of 3

