

**ENVIRONMENTAL ASSESSMENT**  
**For Routine Actions with Limited Environmental Impact**

**Part I. Proposed Action Description**

**1. APPLICANT/CONTACT NAME AND ADDRESS:**

KURTIS HAFFERMAN AND KATHY MINER  
PO BOX 1690  
LIBBY MT 59923-5001

**2. TYPE OF ACTION:**

Surface Water Application for Beneficial Water Use Permit No. 76D 30170983

**3. WATER SOURCE NAME:**

Kootenai River

**4. LOCATION AFFECTED BY PROJECT:**

SWSESE Section 25, Township 31N, Range 31W, Lincoln County and the NWNENE of Section 36, Government lot 1, Township 31N, Range 31W, Lincoln County, Montana.

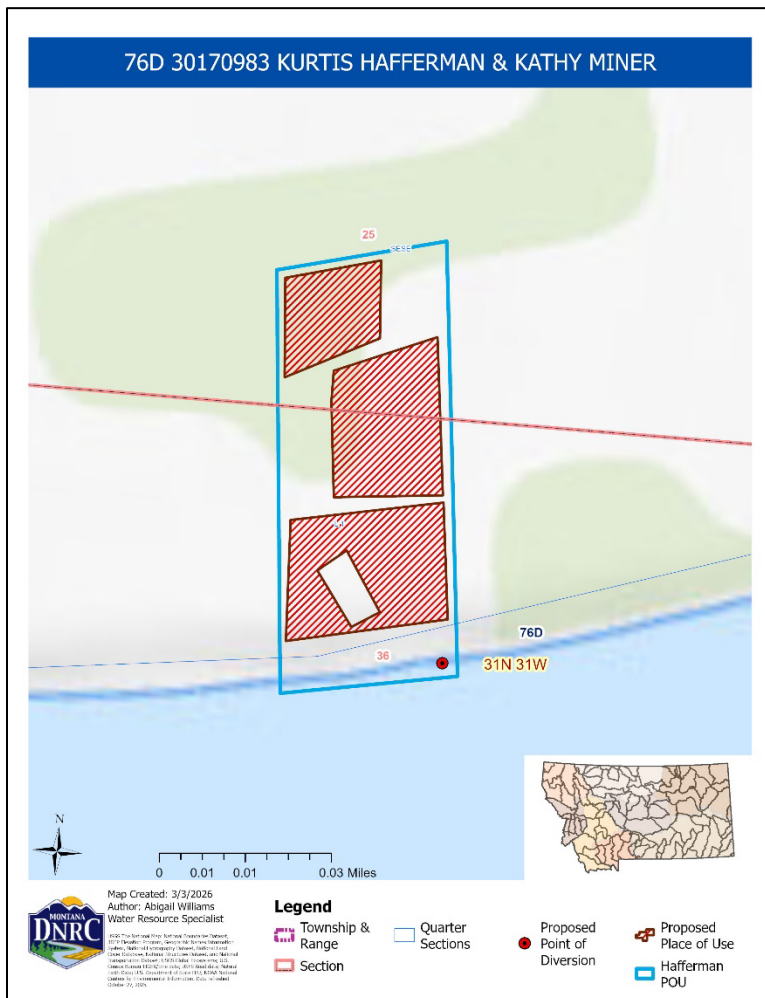

**Figure 1.** Map of the proposed place of use and points of diversion.

**5. NARRATIVE SUMMARY OF THE PROPOSED PROJECT, PURPOSE, ACTION TO BE TAKEN, AND BENEFITS:**

The Applicant proposes to divert water from the Kootenai River by means of an electric pump at a rate of 18.0 gallons per minute up to 0.92 acre-feet from April 15<sup>th</sup> to October 15<sup>th</sup> to irrigate 0.76 acres of lawn and garden.

The proposed point of diversion is located in NWNENE Section 36, Township 31N, Range 31W, Lincoln County Montana (Figure 1). The proposed place of use is located in the SWSESE Section 25, Township 31N, Range 31W, Lincoln County and the NWNENE of Section 36, Township 31N, Range 31W, Lincoln County, Montana (Figure 1).

The project is in the Kootenai River Basin (76D) in an area that is not subject to water right basin closures or controlled groundwater area restrictions.

The DNRC shall issue a water use permit if the Applicant proves the criteria in 85-20-401 MCA are met.

**6. AGENCIES CONSULTED DURING PREPARATION OF THE ENVIRONMENTAL ASSESSMENT:**

- U.S. Fish and Wildlife Service (USFWS): National Wetlands Inventory Wetlands Mapper
- Montana Natural Heritage Program: Endangered, Threatened Species, and Species of Special Concern
- Montana Department of Fish Wildlife & Parks (DFWP): Dewatered Stream Information
- Montana Department of Environmental Quality (MDEQ): Clean Water Act Information Center
- U.S. Natural Resource Conservation Service (NRCS): Web Soil Survey
- U.S. National Park Service (NPS) Water Rights Branch

**Part II. Environmental Review**

---

**1. ENVIRONMENTAL IMPACT CHECKLIST:**

*PHYSICAL ENVIRONMENT*

**1.1 WATER QUANTITY, QUALITY AND DISTRIBUTION**

Water Quantity - Assess whether the source of supply is identified as a chronically or periodically dewatered stream by DFWP. Assess whether the proposed use will worsen the already dewatered condition.

The Applicant proposes to divert water from the Kootenai River which is identified by DFWP as a chronically dewatered stream from the Libby Dam to the Montana-Idaho Border. The Kootenai River is listed as chronically dewatered due to the dam regulating flows. The Department calculated that the physically available water ranges from 250,000 AF to 860,000 AF at the proposed point of diversion during the period of diversion. The Department expects minimal effects as a result of the proposed project.

*Determination:* No significant impact.

Water Quality - Assess whether the stream is listed as water quality impaired or threatened by DEQ, and whether the proposed project will affect water quality.

Kootenai River: MDEQ Clean Water Act Information Center's 2020 Water Quality Information report lists the Flathead River as:

- i. Water Quality Category 5: Waters where one or more applicable beneficial uses have been assessed as being impaired or threatened, and a TLMD is required to address the factors causing the impairment or threat;

- ii. Use Class B-1: Waters classified as suitable for drinking, culinary, and food processing purposes after conventional treatment; bathing, swimming and recreation; growth and propagation of salmonid fishes and associated aquatic life, waterfowl and furbearers; and agricultural and industrial water supply;
- iii. The Kootenai River is assessed as “Fully Supporting” of Agriculture, Drinking water, and Primary Contact Recreation. It is assessed that the Kootenai River is “Not Fully Supporting” of Aquatic Life due to the Temperature of the water and the Flow Regime Modification. A TLMD has not been completed for this impairment.

The proposed diversion of water to irrigate lawn and garden is not expected to significantly affect the water quality on the source.

*Determination:* No significant impact.

Groundwater - Assess if the proposed project impacts ground water quality or supply. If this is a groundwater appropriation, assess if it could impact adjacent surface water flows.

*Determination:* N/A, project does not involve groundwater.

**1.2 DIVERSION WORKS** - Assess whether the means of diversion, construction and operation of the appropriation works of the proposed project will impact any of the following: channel impacts, flow modifications, barriers, riparian areas, dams, well construction.

Applicant proposes to divert water from the Kootenai River at a rate of 18.0 GPM up to 0.92 AF/year to irrigate 0.76 acres of lawn and garden from April 15<sup>th</sup> to October 15<sup>th</sup> via a Grundfos 22 SQ10-160 pump and motor. The pump will be suspended in an 8-inch well casing buried into the bank above the ordinary high water mark with 12-ft of 4-inch PVC pipe connecting to the bottom of the 8-inch well casing buried approximately 6-ft below the ordinary high-water mark to allow intake from the Kootenai River by the pump. The pump outlet connects into a 1-1/2-inch galvanized pipe set into a standard Boshart’s 1-1/2-inch P-150-SS stainless steel pitless adapter that is connected to a 1-½-inch HDPE distribution line. The 1-½-inch HDPE distribution line runs north from the river along the east side of the property where it tees off into 1-inch HDPE later lines for each zone before connecting to the sprinklers via ¾-inch HDPE connection.

The Applicant calculated a maximum TDH for Zone 1 of 175 ft based on an elevation of 20 ft, a length of 565 ft of 1 ½-inch HDPE pipe, and an outlet pressure of 60 PSI. The Applicant provided a pump performance curve for Grundfos 22 SQ10-160. This performance curve demonstrates that the pump can produce 18.0 GPM at a TDH of 175 ft.

The installation of the well casing, pump, and intake pipe is not anticipated to have lasting effects on the riparian area and the channel. The installation will not create any barriers or dams on the Kootenai River. The Applicant must have approval from all relevant agencies before disturbing the stream bank and bed along with the riparian areas for installation of the diversion. The Applicants have stated they will apply for a 310-permit from Lincoln Conservation District, a 404 Permit from USACE, and an MDEQ 318-Permit for this proposed diversion.

*Determination:* Minimal Impact; additional permits are likely required and are the Applicants responsibility to research and obtain.

**1.3 UNIQUE, ENDANGERED, FRAGILE OR LIMITED ENVIRONMENTAL RESOURCES**

Endangered and Threatened Species - Assess whether the proposed project will impact any threatened or endangered fish, wildlife, plants, aquatic species, or any “species of special concern,” or create a barrier to the migration or movement of fish or wildlife. For groundwater, assess whether the proposed project, including

impacts on adjacent surface flows, would impact any threatened or endangered species or “species of special concern.”

The Montana Natural Heritage Program website was reviewed to determine if there are any threatened or endangered fish, wildlife, plants, aquatic species, or any “species of special concern” in the project area that could be impacted by the proposed project. Seventeen animal species (Table 1) were identified within the project area. Of these species, the Grizzly Bear (*Ursus arctos*) and the Bull Trout (*Salvelinus confluentus*) are listed as threatened by the USFWS. This area is already developed. It is not anticipated that any species of concern will be impacted by the proposed project. The Kootenai River has a sufficient amount of water to support and maintain existing populations of Bull Trout, if they should exist there currently and the proposed diversion will not dramatically reduce flows in a way that could affect Bull Trout. This lot is in a planned subdivision where the lots have begun being developed, and the project will not create any barriers to the migration of fish or wildlife.

Table 1. Species of Concern		
Species Group	Common Name	Scientific Name
Mammals	Fisher	<i>Pekania pennanti</i>
Mammals	Fringed Myotis	<i>Myotis thysanodes</i>
Mammals	Grizzly Bear*	<i>Ursus arctos</i>
Mammals	Little Brown Myotis	<i>Myotis lucifugus</i>
Mammals	Northern Hoary Bat	<i>Lasiurus cinereus</i>
Mammals	Silver-haired Bat	<i>Lasionycteris noctivagans</i>
Mammals	Townsend's Big-eared Bat	<i>Corynorhinus townsendii</i>
Mammals	Yuma Myotis	<i>Myotis yumanensis</i>
Birds	Cassin's Finch	<i>Haemorhous cassinii</i>
Birds	Evening Grosbeak	<i>Coccothraustes vespertinus</i>
Birds	Lewis's Woodpecker	<i>Melanerpes lewis</i>
Birds	Pileated Woodpecker	<i>Dryocopus pileatus</i>
Amphibians	Coeur d'Alene Salamander	<i>Plethodon idahoensis</i>
Fish	Bull Trout*	<i>Salvelinus confluentus</i>
Fish	Torrent Sculpin	<i>Cottus rhotheus</i>
Fish	Westslope Cutthroat Trout	<i>Oncorhynchus lewisi</i>
Invertebrates	Hooked Snowfly	<i>Isocapnia crinita</i>

\*Listed as “Threatened” by the USFWS.

*Determination:* No significant impact.

Wetlands & Ponds - Consult and assess whether the apparent wetland is a functional wetland (according to COE definitions), and whether the wetland resource would be impacted. For ponds, consult and assess whether existing wildlife, waterfowl, or fisheries resources would be impacted.

The point of diversion is located on the bank of the Kootenai River where a 1.10 acre Freshwater Forested/Shrub Wetland is located. The proposed diversion will likely temporally affect this area as the proposed plan includes burying the well casing in the bank. The Applicant must obtain all required permits from all relevant agencies prior to disturbing any wetland areas required to complete their project

*Determination:* Potential Impact; additional permits are likely required and are the Applicant’s responsibility to research and obtain.

- 1.4 GEOLOGY/SOIL QUALITY, STABILITY AND MOISTURE** - *Assess whether there will be degradation of soil quality, alteration of soil stability, or moisture content. Assess whether the soils are heavy in salts that could cause saline seep.*

The proposed irrigation of lawn and garden will not negatively impact the soil quality, stability, or moisture content in the project area. The soil type in the project area is, "Andic Dystrochrepts, alluvial terraces" which came from mixed sandy and gravelly alluvium parent material. This soil has a moderately high to high capacity to transmit water. Soils in this area are not typically saline and are therefore not likely susceptible to saline seep.

*Determination:* No significant impact.

- 1.5 VEGETATION COVER, QUANTITY AND QUALITY/NOXIOUS WEEDS** - *Assess impacts to existing vegetative cover. Assess whether the proposed project would result in the establishment or spread of noxious weeds.*

It is not anticipated that this project will impact the existing vegetative cover beyond what has been cleared for construction in the project area. It is not anticipated that issuance of a water use permit will contribute to the establishment or spread of noxious weeds in the project area. Noxious weed prevention and control will be the responsibility of the landowners, who must follow local noxious weed regulations.

*Determination:* No significant impact.

- 1.6 AIR QUALITY** - *Assess whether there will be a deterioration of air quality or adverse effects on vegetation due to increased air pollutants.*

There will be no impact to air quality associated with issuance of the proposed permit for beneficial use of surface water from the Kootenai River.

*Determination:* No significant impact.

- 1.7 HISTORICAL AND ARCHEOLOGICAL SITES** - *Assess whether there will be degradation of unique archeological or historical sites in the vicinity of the proposed project if it is on State or Federal Lands. If it is not on State or Federal Lands simply state NA-project not located on State or Federal Lands.*

*Determination:* N/A, project not located on State or Federal Lands.

- 1.8 DEMANDS ON ENVIRONMENTAL RESOURCES OF LAND, WATER, AND ENERGY** - *Assess any other impacts on environmental resources of land, water, and energy not already addressed.*

All impacts to land, water, and energy have been identified and no further impacts are anticipated.

*Determination:* No significant impact.

#### **HUMAN ENVIRONMENT**

- 1.9 LOCALLY ADOPTED ENVIRONMENTAL PLANS AND GOALS** - *Assess whether the proposed project is inconsistent with any locally adopted environmental plans and goals.*

The project is consistent with planned land uses.

*Determination:* No significant impact.

- 1.10 ACCESS TO AND QUALITY OF RECREATIONAL AND WILDERNESS ACTIVITIES** - *Assess whether the proposed project will impact access to or the quality of recreational and wilderness activities.*

The proposed project will not inhibit, alter, or impair access to present recreational opportunities in the area. The project is not expected to create any significant pollution, noise, or traffic congestion in the area that may alter the quality of recreational opportunities. The proposed place of use and diversion do not exist on land designated as wilderness.

*Determination:* No significant impact.

**1.11 HUMAN HEALTH** - *Assess whether the proposed project impacts human health.*

This proposed use will not adversely impact human health.

*Determination:* No impact.

**1.12 PRIVATE PROPERTY** - *Assess whether there are any government regulatory impacts on private property rights. If yes, analyze any alternatives considered that could reduce, minimize, or eliminate the regulation of private property rights.*

No government regulatory impacts on private property rights.

*Determination:* No impact.

**1.13 OTHER HUMAN ENVIRONMENTAL ISSUES** - *For routine actions of limited environmental impact, the following may be addressed in a checklist fashion.*

Impacts on:

- (a) Cultural uniqueness and diversity? None identified.
- (b) Local and state tax base and tax revenues? None identified.
- (c) Existing land uses? None identified.
- (d) Quantity and distribution of employment? None identified.
- (e) Distribution and density of population and housing? None identified.
- (f) Demands for government services? None identified.
- (g) Industrial and commercial activity? None identified.
- (h) Utilities? None identified.
- (i) Transportation? None identified.
- (j) Safety? None identified.
- (k) Other appropriate social and economic circumstances? None identified.

**2. SECONDARY AND CUMULATIVE IMPACTS ON THE PHYSICAL ENVIRONMENT AND HUMAN POPULATION:**

Secondary Impacts: None identified.

Cumulative Impacts: None identified.

**3. DESCRIBE ANY MITIGATION/STIPULATION MEASURES:**

None.

**4. DESCRIPTION AND ANALYSIS OF REASONABLE ALTERNATIVES TO THE PROPOSED ACTION, INCLUDING THE NO ACTION ALTERNATIVE, IF AN ALTERNATIVE IS REASONABLY AVAILABLE AND PRUDENT TO CONSIDER:**

The only alternative to the proposed action would be the no action alternative. The no action alternative would not authorize the diversion of groundwater at this location.

### **Part III. Conclusion**

---

**1. PREFERRED ALTERNATIVE:**

Issue a water use permit if the Applicant proves the criteria in 85-20-401 MCA are met.

**2. COMMENTS AND RESPONSES:**

None.

**3. FINDING:**

*Based on the significance criteria evaluated in this EA, is an EIS required? \_\_\_Yes XNo*

*If an EIS is not required, explain why the EA is the appropriate level of analysis for this proposed action:*

No significant impacts related to the proposed project have been identified.

**4. NAME OF PERSON(S) RESPONSIBLE FOR PREPARATION OF EA:**

*Name:* Abigail Williams

*Title:* Water Resource Specialist

*Date:* 03/10/2026



# Montana Fish, Wildlife & Parks

## FWP DEWATERING CONCERN AREAS

Revised, May 2005

The following is a list of Montana streams that support important fisheries or contribute to important fisheries (i.e., provide spawning and rearing habitats) that are significantly dewatered. Dewatering refers to a reduction in streamflow below the point where stream habitat is adequate for fish.

This is the third revision of the Dewatered Streams List compiled by FWP dated January 24, 1991 and last updated in May 2003. List entries and updates were provided by FWP regional fisheries biologists from field observations. Further revisions may be necessary as water use patterns change, and additional or more detailed information becomes available.

This revised list includes a total of 323 stream reaches on 314 streams, which are chronically dewatered, and 113 stream reaches on 109 streams, which are periodically dewatered. The reaches do not overlap between categories.

The two categories of dewatering are:

1. **Chronic dewatering** -- streams where dewatering is a significant problem in virtually all years; and
2. **Periodic dewatering** -- streams where dewatering is a significant problem only in drought or water-short years.

Most man-made dewatering occurs during the irrigation season (July-September). Although most dewatering is caused by irrigation withdrawals, a few of the listed waters are dewatered through dam regulation for agricultural and power production purposes or by natural causes.

Each listed stream shows the length (in miles) of the dewatered reach. For larger/longer streams, the boundaries of the dewatered reach (Point A - Point B) are given. For streams that have no reach boundaries given, the miles shown as dewatered are from the mouth upstream. All mileages are approximate.

The dewatered reaches shown are typical for the stream. However, the number of miles dewatered may vary from year to year depending upon the amount of water available in the stream system.

## CHRONIC DEWATERING

<u>STREAM AND REACH</u>	<u>MILES DEWATERED</u>
<b>Beaverhead-Red Rock River Drainage</b>	
Beaverhead River: West Side Canal – mouth	39
Big Sheep Creek: BLM Boundary - Red Rock River	3
Blacktail Deer Creek: Axes Canyon Rd - Beaverhead River	5.5
Horse Prairie Creek: Red Butte - Clark Canyon Reservoir	15
Junction Creek: I-15 - Red Rock River	4
Rattlesnake Creek: Dillon/Argenta Rd - mouth	7.5
Red Rock River: Dell-Briggs Ranch	<u>6</u>
Subtotal for Drainage	80.0
<b>Big Hole River Drainage</b>	
Alder Creek	0.1
Big Hole River:	
Big Lake Creek - Swamp Creek	9
Glen Bridges - mouth	24.4
Birch Creek: Beaverhead/Willow Ditch - mouth	9.8
Governor Creek	5
Wise River: Wise River Ditch - mouth	<u>5</u>
Subtotal for Drainage	53.3
<b>Bitterroot River Drainage</b>	
Baker Creek	1
Bass Creek	1
Bear Creek:	
North Channel	4
South Channel	4
Big Creek	3
Bitterroot River: Corvallis-Stevensville	17
Blodgett Creek	2
Burnt Fork Creek	5
Carlton Creek	5
Chaffin Creek	2
Eightmile Creek	3
Kootenai Creek	2
Lolo Creek	3
Lost Horse Creek	4
Mill Creek	3
Mill Creek (Trib. to Lolo Creek)	0.5
O'Brien Creek	1.5
Reimel Creek	1
Rock Creek	5
Skalkaho Creek	4
South Fork of Lolo Creek	0.5
Sweathouse Creek	2

**Dearborn River Drainage**

Dearborn River: Bean Lake Canal – mouth	44
Middle Fork Dearborn River	<u>4</u>
Subtotal for Drainage	48

**Flathead River Drainage**

Lost Creek: 4 miles Above Lore Lake - Stillwater River	7
Mount Creek: Welcome Springs - mouth	5
South Fork Flathead River: Hungry Horse Dam - mouth	5.3
Walker Creek: Entire Length	<u>7</u>
Subtotal for Drainage	24.3

**Flint Creek Drainage (Clark Fork)**

Cow Creek	3
Douglas Creek	2
Flint Creek: Georgetown Lake - mouth	42.4
Gird Creek	1
Henderson Creek: USFS Boundary - mouth	4
Lower Willow Creek: Reservoir - mouth	9.4
Marshall Creek: USFS Boundary - mouth	<u>5</u>
Subtotal for Drainage	66.8

**Gallatin River Drainage**

Baker Creek	10
Big Bear Creek	5
Bridger Creek	10
Gallatin River: Shedd's Bridge - Mouth	32.7
Hyalite (Middle) Creek	20
South Cottonwood Creek	<u>6</u>
Subtotal for Drainage	83.7

**Jefferson River Drainage**

Antelope Creek	7
Boulder River: Boulder - Cold Springs	36
Fish Creek	10
Jefferson River: Headwaters - mouth	84
Little Boulder River	10
North Willow Creek	9
Pipestone Creek	8
South Boulder River	10
South Willow Creek	8
Whitetail Creek	<u>24</u>
Subtotal for Drainage	206

**Judith River Drainage**

Cottonwood Creek: McMillan ditch to Big Spring Creek	17
Judith River: Ackley Lake diversion – Big Spring Creek	37
Ross Fork Creek	<u>10</u>
Subtotal for Drainage	64

## PERIODIC DEWATERING

<u>STREAM AND REACH</u>	<u>MILES DEWATERED</u>
<b>Beaverhead - Red Rock River Drainage</b>	
Beaverhead River: Clark Canyon Dam - West Side Canal	21
Big Beaver Creek	0.7
Blacktail Deer Creek: West Fork - Axes Canyon Rd.	19.8
Bloody Dick Creek (Tributary to Horse Prairie Cr.)	10
Grasshopper Creek:	
Polaris - Bannock	14
Frenzy Place Placer - mouth	6
Jones Creek: BLM boundary - mouth	1.5
Little Sheep Creek: Road crossing - mouth	7.5
Medicine Lodge Creek (Tributary to Horse Prairie Cr.): Ayers Cyn - mouth	16.8
Peet Creek: Jones Diversion - mouth	1.7
Sage Creek: Rock Island Ranch - mouth	11
Trail Creek (Tributary to Horse Prairie Cr.): Source - mouth	<u>7</u>
Subtotal for Drainage	117.0
 <b>Big Hole River Drainage</b>	
Big Hole River:	
Hamby Creek - Big Lake Creek	23.4
Swamp Creek - Glen Bridges	84.5
Big Lake Creek	7.5
Canyon Creek	6
Deep Creek	5.1
Divide Creek	9.5
Doolittle Creek	1.5
Fishtrap Creek	2.4
Francis Creek	7.7
Jerry Creek	3.1
Johnson Creek	3.7
Moose Creek	3.0
Mussigbrod Creek	9.4
North Fork Big Hole River	25
Pintlar Creek	10.8
Rock Creek	3
Rock Creek (Tributary to Big Lake Cr)	7
Ruby Creek	4.3
Sandhollow Creek	4.8
Steel Creek	8.6
Swamp Creek	17.4
Trapper Creek	6
Warm Springs Creek	9
Willow Creek	<u>5.5</u>
Subtotal for Drainage	268.2

**Bitterroot River Drainage**

Lolo Creek	<u>1</u>
Subtotal for Drainage	1

**Blackfoot River Drainage**

Arkansas Creek	2
Ashby Creek	2
Blackfoot River: Stream mile 84.9-54.1	30.8
Clearwater River	3.5
Elk Creek	3
Hoyt Creek	1
Nevada Creek: Stream mile 34.0-40.0	6
Shanley Creek	<u>1.6</u>
Subtotal for Drainage	49.9

**Dearborn River Drainage**

South Fork Dearborn River	<u>10</u>
Subtotal for Drainage	10

**Flathead River Drainage**

Ashley Creek: US Hwy. 2 Bridge – mouth	20
Blaine Creek: Above Lake Blaine - Lake Blaine	3
Bowser Spring Creek: Hwy 424 - Kalispell	8
Dayton Creek: Co. Line - mouth	10
Echo Creek: Sec. 27 - mouth	3
Evergreen Spring Creek	5
Garnier Creek: USFS - mouth	3
Lynch Creek: Sec. 12 - mouth	5
Meadow Creek (Big Fork): USFS - mouth	3
Ronan Creek: Lake Mary Ronan - mouth	5
Spring Creek: North of Kalispell	5
Trumbull Creek: USFS - Rose Crossing	<u>20</u>
Subtotal for Drainage	90

**Gallatin River Drainage**

Bozeman (Sourdough) Creek	8
Gallatin River: Gallatin Gateway - Shedd's Bridge	<u>5.3</u>
Subtotal for Drainage	13.3

**Jefferson River Drainage**

Hells Canyon Creek*	0.3
Willow Creek	<u>10</u>
Subtotal for Drainage	10.3

**Judith River Drainage**

Judith River: Utica to Ackley Lake diversion	<u>5</u>
Subtotal for Drainage	5

## Assessment Record Summary

Reporting Cycle: 2020

Assessment Record: MT76D001\_010

Status: Unassigned

### WATER INFORMATION

Status: Unassigned

**Reporting Cycle:** 2020  
**Assessment Unit:** MT76D001\_010  
**Name:** Kootenai River  
**Location Description:** KOOTENAI RIVER, Libby Dam to Yaak River

Water Type:	Size (Miles/Acres)	Use Class:
RIVER	44.64 MILES	B-1

**Trophic Status:**

**Trophic Trend:**

**1 - Hydrologic Unit Code:** 17010101  
**2 - HUC Name:** Middle Kootenai  
**3 - Watershed:** Kootenai  
**4 - Basin:** Columbia  
**5 - TMDL Planning Area:** Kootenai  
**6 - Ecoregion:** Northern Rockies  
**7 - County:** Lincoln County  
**8 - LAT/LONG AU Upstream:** Start: 48.410513 / -115.314244  
**9 - LAT/LONG AU Downstream:** End: 48.560619 / -115.977976

**Water Quality Category:** 5 - Waters where one or more applicable beneficial uses have been assessed as being impaired or threatened, and a TMDL is required to address the factors causing the impairment or threat.

## Assessment Record Summary

Reporting Cycle: 2020

Assessment Record: MT76D001\_010

Status: Unassigned

Beneficial Use Support Information					
Use Name	Fully Supporting	Not Fully Supporting	Threatened	Insufficient Information	Not Assessed
Aquatic Life		X			
Agricultural	X				
Drinking Water	X				
Primary Contact Recreation	X				

Assessment Information		
Use Name	Assessment Type	Assessment Confidence
NA		

Use Name	Assessment Methods
NA	

Impairment Information			
Use Name	Probable Causes	Probable Sources	TMDL Completed
Aquatic Life	Temperature	Impacts from Hydrostructure Flow Regulation/modification	N
		Dam or Impoundment	
	Flow Regime Modification	Impacts from Hydrostructure Flow Regulation/modification	N
		Dam or Impoundment	

## Assessment Record Summary

Reporting Cycle: 2020

Assessment Record: MT76D001\_010

Status: Unassigned

Use Name	Observed Effects
NA	

Delisting / Category Changes			
Cause	Reason for Change	Change Date	Comments
NA			



## Montana SOC Occurrences Report

### SOC Occurrences with MT Status = Species of Concern

Report generated 2/10/2026 9:29:19 AM

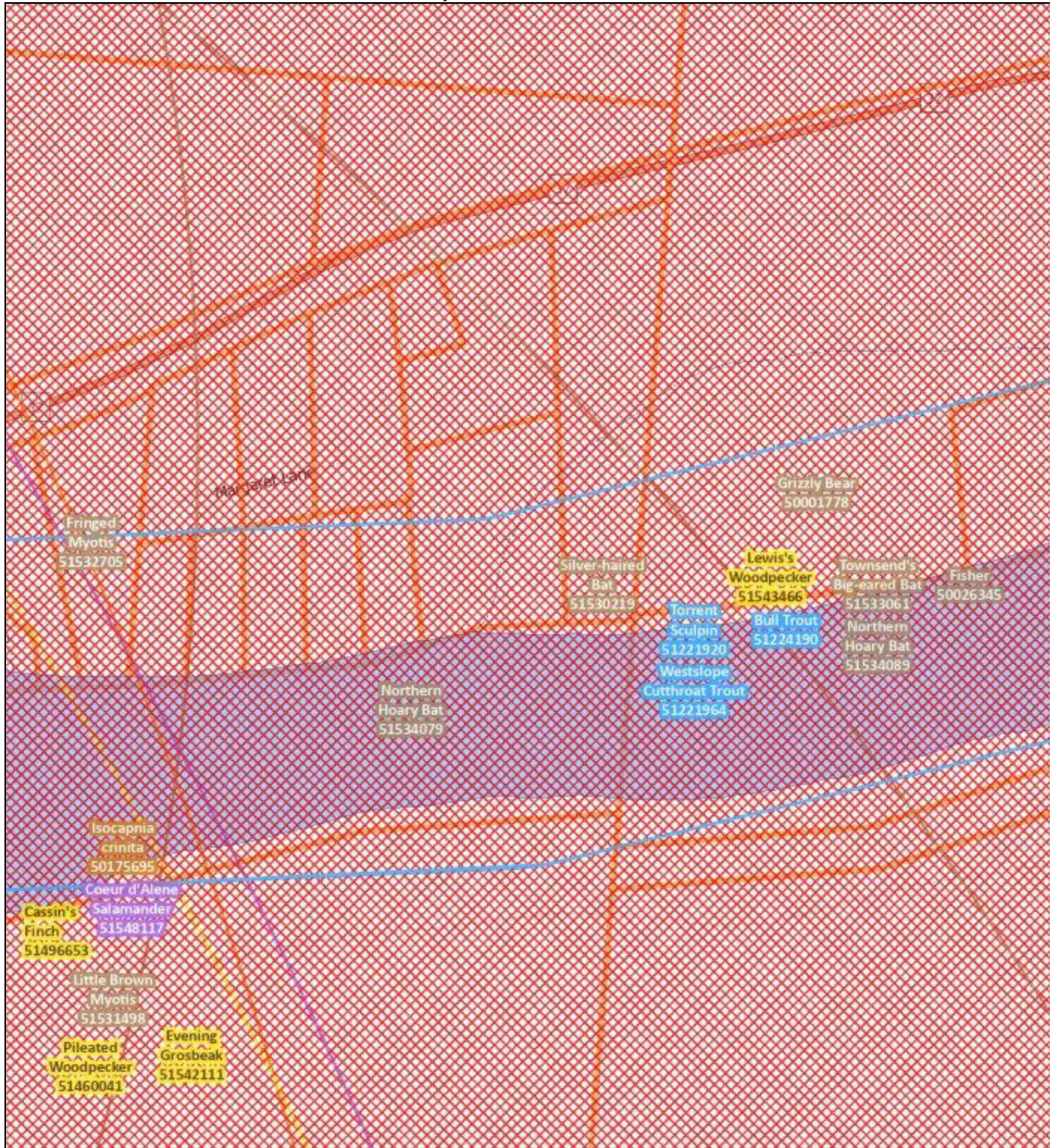

⊕ **Mammals - Fisher** (*Pekania pennanti*)

	SO Count: 1	Obs Count: 91	Earliest Obs: 1965	Recent Obs: 2022
<input type="checkbox"/> <b>Mammals - Fringed Myotis</b> ( <i>Myotis thysanodes</i> )				
	SO Count: 1	Obs Count: 1	Earliest Obs: 2024	Recent Obs: 2024
<input type="checkbox"/> <b>Mammals - Grizzly Bear</b> ( <i>Ursus arctos</i> )				
	SO Count: 1	Obs Count: 461	Earliest Obs: 1912	Recent Obs: 2023
<input type="checkbox"/> <b>Mammals - Little Brown Myotis</b> ( <i>Myotis lucifugus</i> )				
	SO Count: 2	Obs Count: 2	Earliest Obs: 1967	Recent Obs: 2024
<input type="checkbox"/> <b>Mammals - Northern Hoary Bat</b> ( <i>Lasiurus cinereus</i> )				
	SO Count: 3	Obs Count: 3	Earliest Obs: 1995	Recent Obs: 2024
<input type="checkbox"/> <b>Mammals - Silver-haired Bat</b> ( <i>Lasionycteris noctivagans</i> )				
	SO Count: 2	Obs Count: 2	Earliest Obs: 1995	Recent Obs: 1995
<input type="checkbox"/> <b>Mammals - Townsend's Big-eared Bat</b> ( <i>Corynorhinus townsendii</i> )				
	SO Count: 1	Obs Count: 1	Earliest Obs: 2024	Recent Obs: 2024
<input type="checkbox"/> <b>Mammals - Yuma Myotis</b> ( <i>Myotis yumanensis</i> )				
	SO Count: 1	Obs Count: 2	Earliest Obs: 2011	Recent Obs: 2011
<input type="checkbox"/> <b>Birds - Cassin's Finch</b> ( <i>Haemorhous cassinii</i> )				
	SO Count: 1	Obs Count: 1	Earliest Obs: 1995	Recent Obs: 1995
<input type="checkbox"/> <b>Birds - Evening Grosbeak</b> ( <i>Coccothraustes vespertinus</i> )				
	SO Count: 1	Obs Count: 1	Earliest Obs: 1995	Recent Obs: 1995
<input type="checkbox"/> <b>Birds - Lewis's Woodpecker</b> ( <i>Melanerpes lewis</i> )				
	SO Count: 2	Obs Count: 3	Earliest Obs: 2020	Recent Obs: 2022
<input type="checkbox"/> <b>Birds - Pileated Woodpecker</b> ( <i>Dryocopus pileatus</i> )				
	SO Count: 1	Obs Count: 1	Earliest Obs: 1991	Recent Obs: 1991
<input type="checkbox"/> <b>Amphibians - Coeur d'Alene Salamander</b> ( <i>Plethodon idahoensis</i> )				
	SO Count: 1	Obs Count: 1	Earliest Obs: 1969	Recent Obs: 1969
<input type="checkbox"/> <b>Fish - Bull Trout</b> ( <i>Salvelinus confluentus</i> )				
	SO Count: 1	Obs Count: 485	Earliest Obs: 1959	Recent Obs: 2022
<input type="checkbox"/> <b>Fish - Torrent Sculpin</b> ( <i>Cottus rhotheus</i> )				
	SO Count: 1	Obs Count: 29	Earliest Obs: 1950	Recent Obs: 2020
<input type="checkbox"/> <b>Fish - Westslope Cutthroat Trout</b> ( <i>Oncorhynchus lewisi</i> )				
	SO Count: 1	Obs Count: 324	Earliest Obs: 1969	Recent Obs: 2021
<input type="checkbox"/> <b>Invertebrates - <i>Isocapnia crinita</i></b> (Hooked Snowfly)				
	SO Count: 1	Obs Count: 1	Earliest Obs: 1988	Recent Obs: 1988

**Citation for this report:**

Montana SOC Occurrences Report

SOC Occurrences with MT Status = Species of Concern

Within Lat/Long: (48.40618,-115.47482) to (48.42114,-115.51049)

Natural Heritage Map Viewer. Montana Natural Heritage Program.

Retrieved on February 10, 2026, from <https://mtnhp.org/MapView/SORReport.aspx>

Soil Map—Kootenai National Forest Area, Montana-Idaho  
(76D 30170983)



Soil Map may not be valid at this scale.

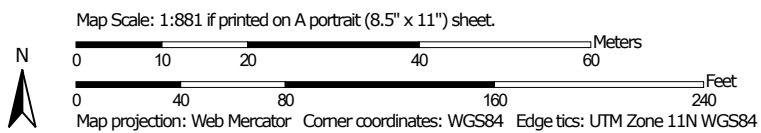



## MAP LEGEND

### Area of Interest (AOI)

 Area of Interest (AOI)

### Soils

 Soil Map Unit Polygons

 Soil Map Unit Lines

 Soil Map Unit Points

### Special Point Features



Blowout



Borrow Pit



Clay Spot



Closed Depression



Gravel Pit



Gravelly Spot



Landfill



Lava Flow



Marsh or swamp



Mine or Quarry



Miscellaneous Water



Perennial Water



Rock Outcrop



Saline Spot



Sandy Spot



Severely Eroded Spot



Sinkhole



Slide or Slip



Sodic Spot



Spoil Area



Stony Spot



Very Stony Spot



Wet Spot



Other



Special Line Features

### Water Features



Streams and Canals

### Transportation



Rails



Interstate Highways



US Routes



Major Roads



Local Roads

### Background



Aerial Photography

## MAP INFORMATION

The soil surveys that comprise your AOI were mapped at 1:24,000.

Warning: Soil Map may not be valid at this scale.

Enlargement of maps beyond the scale of mapping can cause misunderstanding of the detail of mapping and accuracy of soil line placement. The maps do not show the small areas of contrasting soils that could have been shown at a more detailed scale.

Please rely on the bar scale on each map sheet for map measurements.

Source of Map: Natural Resources Conservation Service

Web Soil Survey URL:

Coordinate System: Web Mercator (EPSG:3857)

Maps from the Web Soil Survey are based on the Web Mercator projection, which preserves direction and shape but distorts distance and area. A projection that preserves area, such as the Albers equal-area conic projection, should be used if more accurate calculations of distance or area are required.

This product is generated from the USDA-NRCS certified data as of the version date(s) listed below.

Soil Survey Area: Kootenai National Forest Area, Montana-Idaho

Survey Area Data: Version 25, Aug 30, 2025

Soil map units are labeled (as space allows) for map scales 1:50,000 or larger.

Date(s) aerial images were photographed: Jul 14, 2023—Aug 13, 2023

The orthophoto or other base map on which the soil lines were compiled and digitized probably differs from the background imagery displayed on these maps. As a result, some minor shifting of map unit boundaries may be evident.

## Map Unit Legend

Map Unit Symbol	Map Unit Name	Acres in AOI	Percent of AOI
103	Andic Dystrachrepts, alluvial terraces	2.9	98.0%
W	Water	0.1	2.0%
<b>Totals for Area of Interest</b>		<b>3.0</b>	<b>100.0%</b>

## Kootenai National Forest Area, Montana-Idaho

### 103—Andic Dystrochrepts, alluvial terraces

#### Map Unit Setting

*National map unit symbol:* nvcq

*Elevation:* 2,000 to 3,500 feet

*Mean annual precipitation:* 30 to 50 inches

*Mean annual air temperature:* 43 to 46 degrees F

*Frost-free period:* 90 to 110 days

*Farmland classification:* Farmland of statewide importance

#### Map Unit Composition

*Andic dystrochrepts and similar soils:* 90 percent

*Estimates are based on observations, descriptions, and transects of the mapunit.*

#### Description of Andic Dystrochrepts

##### Setting

*Landform:* Stream terraces

*Parent material:* Mixed sandy and gravelly alluvium

##### Typical profile

*Oi - 0 to 1 inches:* slightly decomposed plant material

*Bs - 1 to 8 inches:* gravelly silt loam

*2A - 8 to 21 inches:* very gravelly fine sandy loam

*2Bw - 21 to 42 inches:* very gravelly fine sandy loam

*2Cd - 42 to 62 inches:* very cobbly loamy sand

##### Properties and qualities

*Slope:* 0 to 15 percent

*Depth to restrictive feature:* More than 80 inches

*Drainage class:* Well drained

*Capacity of the most limiting layer to transmit water (Ksat):*

Moderately high to high (0.57 to 1.98 in/hr)

*Depth to water table:* More than 80 inches

*Frequency of flooding:* None

*Frequency of ponding:* None

*Available water supply, 0 to 60 inches:* Low (about 4.8 inches)

##### Interpretive groups

*Land capability classification (irrigated):* None specified

*Land capability classification (nonirrigated):* 7e

*Hydrologic Soil Group:* B

*Ecological site:* F043AP910MT - Upland Cool Moist Woodland Group

*Other vegetative classification:* western redcedar/queencup  
beadlily (PK530), western hemlock/queencup beadlily (PK570)

*Hydric soil rating:* No

## **Data Source Information**

Soil Survey Area: Kootenai National Forest Area, Montana-Idaho  
Survey Area Data: Version 25, Aug 30, 2025



February 25, 2026

**Wetlands**

- Estuarine and Marine Deepwater
- Freshwater Emergent Wetland
- Estuarine and Marine Wetland
- Freshwater Forested/Shrub Wetland
- Freshwater Pond
- Lake
- Other
- Riverine

This map is for general reference only. The US Fish and Wildlife Service is not responsible for the accuracy or currentness of the base data shown on this map. All wetlands related data should be used in accordance with the layer metadata found on the Wetlands Mapper web site.