



COST SHARE AGREEMENT
Between the
MONTANA DEPARTMENT OF NATURAL RESOURCES AND CONSERVATION
EASTERN LAND OFFICE
and the
USDI BUREAU OF LAND MANAGEMENT
EASTERN MONTANA DAKOTAS DISTRICT

This cost share agreement is between the agencies identified above, as negotiated for the following incident in accordance with the Statewide Cooperative Fire Protection Agreement #11-FI-110156000-006 executed between the parties on (8/25/2011). The purpose of this agreement is to provide for a coordinated cooperative fire suppression operation on this fire and to describe the cost division.

General Incident Information:

Incident Name: Mud Draw Fire
Incident Start Date and Time: July 12, 2016 15:38
Location: Latitude: 45 42.9770 Longitude: -106 35 .5260
Estimated Size: Acres at the time of this agreement: 341
Incident Cause: Lightning

Incident Numbers by Protection Agency:

Agency	Incident #	Accounting Code
Montana DNRC	MT-MCD-000177	846006
BLM	MT-MCD-000177	KFF6

Cost Share Period: This agreement becomes effective on the date indicated below and will remain in effect until amended or terminated.

Start date/time: 7/12/2016, 15:38

End date/time: 7/15/2016, 23:59

Other conditions relative to this agreement:

1. Costs incurred by cooperators not engaged with the host agency or IMT in the fire suppression activities will not be included as a part of this cost share agreement.
2. Responsibility for tort claim costs will not be a part of this agreement. Responsibility for these costs will be determined outside this agreement.
3. Costs for accountable, sensitive, and durable property purchased by each agency will be charged directly to that agency and will not be shared.
4. Non-suppression rehabilitation costs are the responsibility of the jurisdictional agency and will not be shared.



5. Each agency will bill for their costs as outlined in the MONTANA COOPERATIVE FIRE MANAGEMENT and STAFFORD ACT RESPONSE AGREEMENT #11-FI-110156000-006 executed between the parties on (8/25/2011) billing procedures.

Cost Share Methodology:

The cost share will be based on a percentage of protection responsibility acres within the area defined by the final fire boundary on the date the fire is declared out. The costs to be shared include all costs associated with the management of the incident, including structure protection. The decision was made to use the actual acreage burned in each agency's protection responsibility because of equal effort expended on all areas of the incident.

Final Agency Apportionment:

1. Federal Share:

a.	BLM	38%
----	-----	-----

2. State Share :

a.	MT	62%
----	----	-----

Principal Contacts:

The following personnel are the principal contacts:

Title:	Name:	Agency:
Agency Administrator	Chris Pileski	MT DNRC
Agency Administrator	Diane Friez	USDI BLM
Incident Business Advisor(s)		
Incident Commander(s)	Dresbach/Harding	Rosebud Co/BLM



Signatures of Authorized Personnel & Attachments:

This agreement and the apportionment described are our best judgments of fair and equitable agency cost responsibilities.

Attachments:

Cost Share Map

USDI Bureau of Land Management
Eastern Montana/Dakotas District
111 Garryowen Road
Miles City, MT 59301

Signature: _____

Diane Friez, District Manager

Date: _____

7/21/2016

Montana Department of Natural Resources and Conservation
Eastern Land Office
321 Main Street
Miles City, Montana 59301

Signature: _____

Chris Pileski, Area Manager

Date: _____

7/25/16



Mud Draw 7/12/2016
PRI: 212.9; BLM: 128.4
Total: 341.3 acres

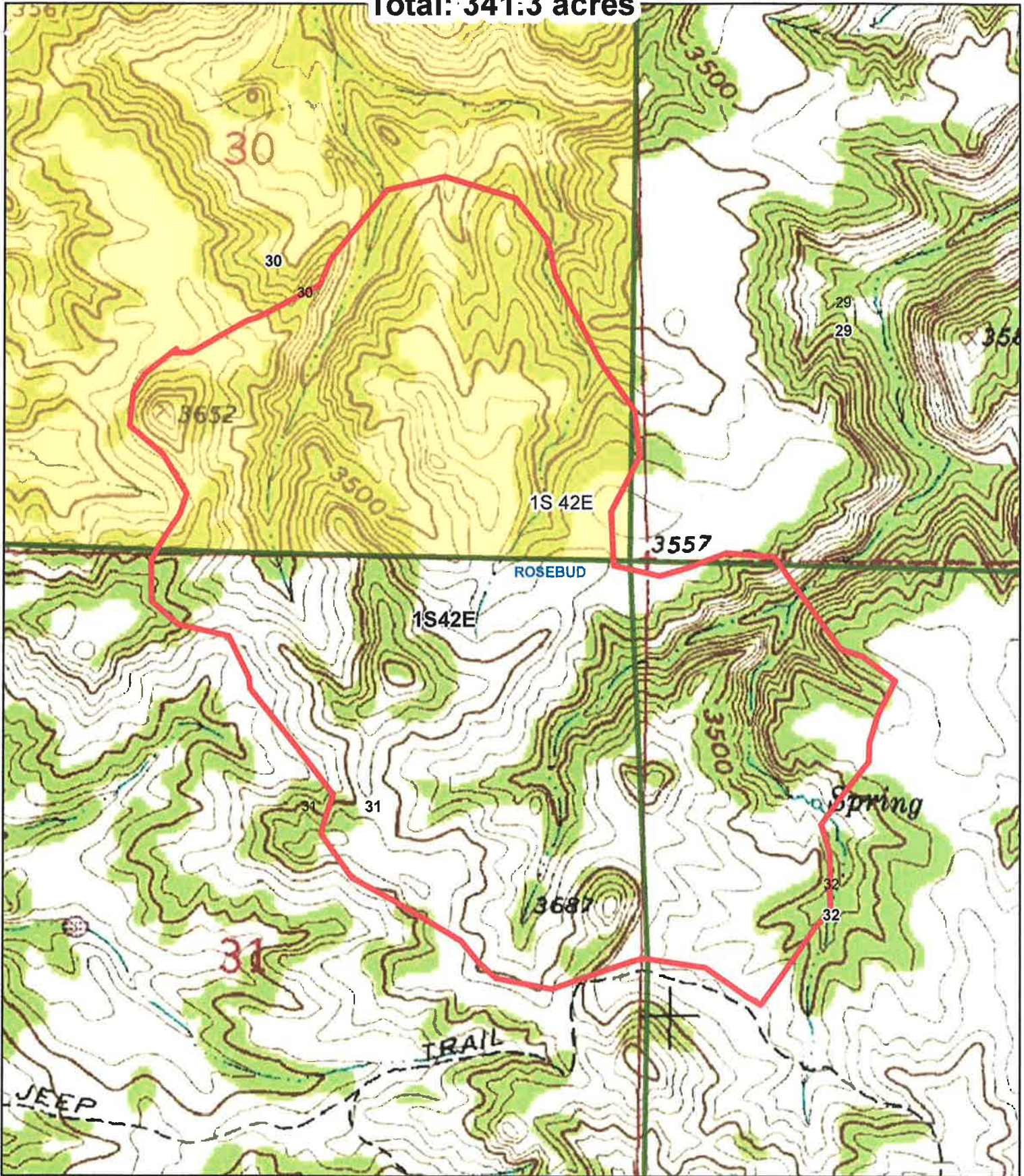

CAUTION:
 Land ownership data is derived from less accurate data than the 1:24000 scale base map. Therefore, land ownership may not be shown for parcels smaller than 40 acres, and land ownership lines may have plotting errors due to source data. No warranty is made by the Bureau of Land Management or the use of the data for purposes not intended by the BLM.

0 0.125 0.25 0.5 Miles

United States Department of the Interior
 Bureau of Land Management

1:10,000

