

USING THE MAP

When you zoom in on a county map, you will see the nominated tracts outlined in red, with the application or tract number displayed in or adjacent to the tract. The legal location (i.e. township, range and section) given for each tract on the lease sale list can also be seen on the map. For example, the nominated tract shown below is App# 5070 and is Section 16 located in Township 4 South, Range 24 East.

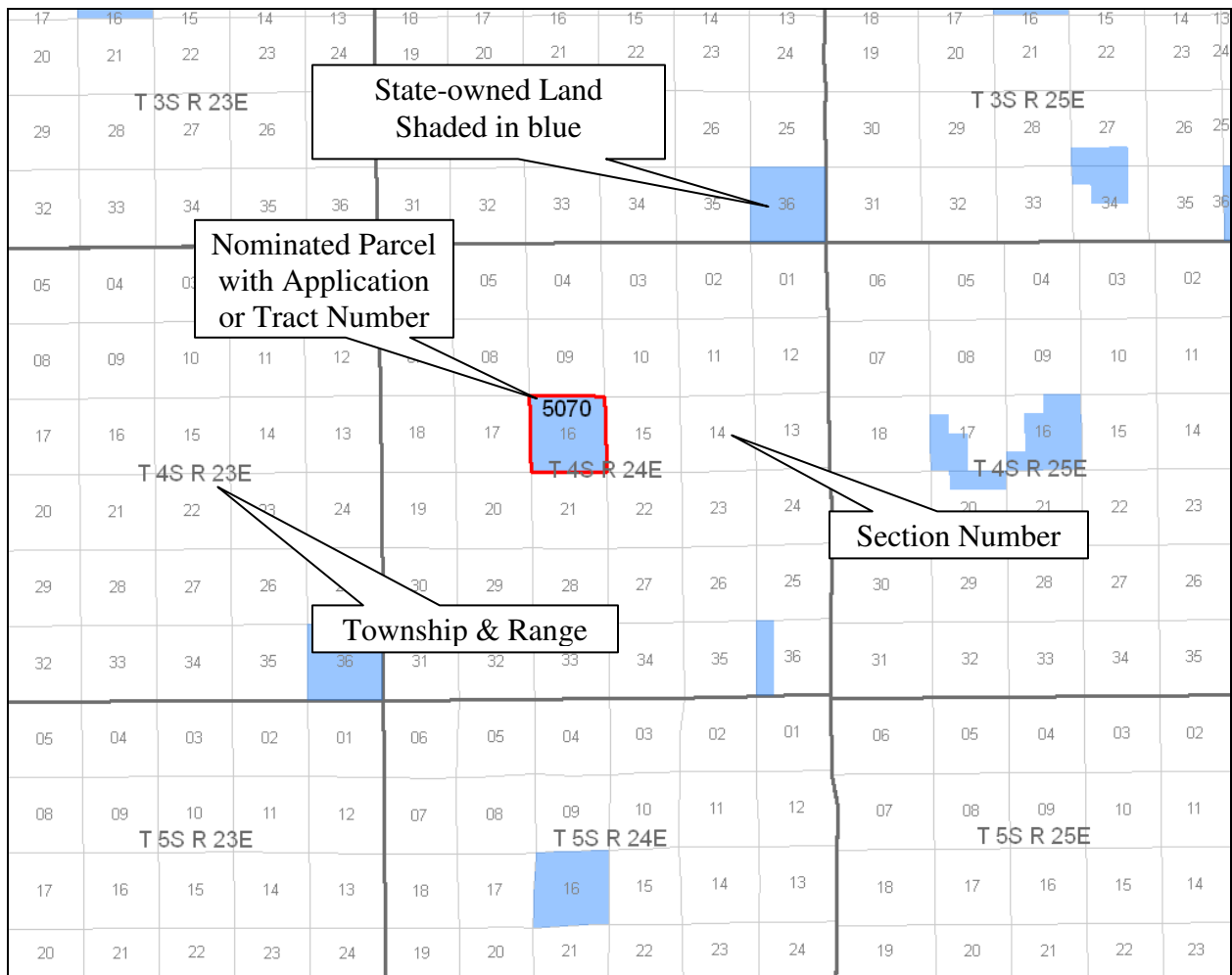

Note: Nominated tracts are referred to by “App#” on the preliminary lease sale list, and by “Tract#” on the final lease sale list.