

Certificate of Survey

Government Lots 3 and 4, Section 20

Township 31 North, Range 22 West, Principal Meridian, Flathead County, Montana

20

Northeast 1/4 of
the Northwest 1/4

Government Lot 2

Government Lot 4

Cert. of Survey
No. 18353Cert. of Survey
No. 20364Certificate
of Survey
No. 18353

Government Lot 3

Beaver Lake

Basis of Bearing - geodetic North
per real time kinematic global positioning
system survey single point calibration

300 150 0 300 600

Scale in feet

LEGEND

Section corner.
Found 3 1/4" diameter brass cap marked as shown.Quarter section corner.
Found 3 1/4" diameter brass cap marked as shown.

(Rec 1) Record measurement per Certificate of Survey No. 18353

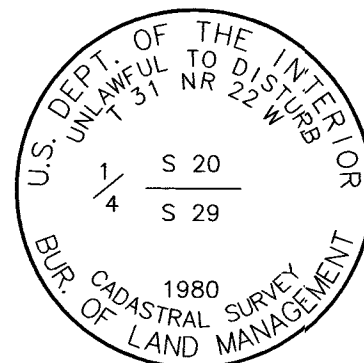
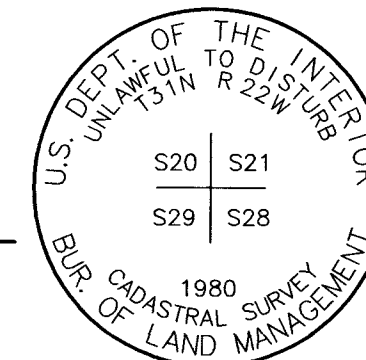
POST OFFICE BOX 1144
SUPERIOR, MT 59872
PHONE 406-822-532920
29N88°32'49"E
(Rec 1)2653.65'
(Rec 1)20
2921
28

Owner: State of Montana School Trust Lands
Date of survey: April 2022
Purpose: Retracement of amended lease boundaries
Commissioned by: State of Montana Department of
Natural Resources and Conservation

PURPOSE OF SURVEY

The purpose of this survey is to retrace the amended boundaries of lease Lots 14, 15 and 16 shown on Certificate of Survey No. 18353. This division of land does not create a second or subsequent parcel from a single tract for sale, rent or lease for residential purposes, and is not subject to the requirements of Title 76 Chapter 3, Montana Code Annotated.

CERTIFICATE OF PROFESSIONAL LAND SURVEYOR

I hereby certify that I am a Licensed Professional Land Surveyor in the State of Montana, that the survey shown on this Certificate of Survey has been prepared in accordance with Montana Code Annotated Title 76 Chapter 3 and the Montana Department of Labor and Industry Administrative Rules for the Montana, Subdivision and Platting Act, Uniform Standards for Survey Monumentation, Certificates of Survey and Final Subdivision Plats.

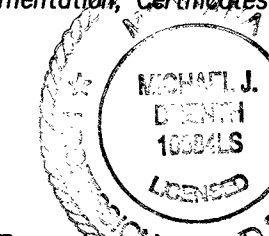
Dated this 4th day of August, 2022.Michael J. Drenth
Montana License No. 10684LS

NOTE

Surveyor has made no investigative or independent search for easements of record, encumbrances, restrictive covenants, ownership title evidence, or any other facts that an accurate and current title search may disclose.

Approved: 8-8-2022

Examining Land Surveyor
Lic. No. 7328LSState of Montana } SS
County of Flathead }Filed on the 15th day of August, 2022 A.D. at 12:36 P.M.Debbie Pierson By Deputy
County Clerk and RecorderInstrument Rec. No. 202200021449
Fee \$26.50

COS# 22282

202200021449 Fees: \$26.50 by: JW
by Eby & Associates Inc
Date 8/15/2022 Time 12:36 PM
Debbie Pierson, Flathead County Montana

Page 1 of 2
Certificate of Survey No. 22282

Certificate of Survey

Government Lots 3 and 4, Section 20

Township 31 North, Range 22 West, Principal Meridian, Flathead County, Montana

Owner: State of Montana School Trust Lands
Date of survey: April 2022
Purpose: Retracement of amended lease boundaries
Commissioned by: State of Montana Department of Natural Resources and Conservation

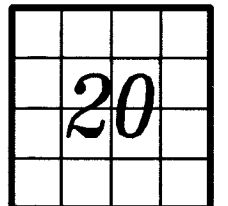

LEGAL DESCRIPTIONS

Lot 14

That portion of Government Lot 3 and Government Lot 4, Section 20, Township 31 North, Range 22 West, Principal Meridian, Flathead County, Montana described as follows:

BEGINNING at a point that bears North 36°40'39" West 4395.81 feet from the Southeast Corner of Section 20, Township 31 North, Range 22 West; thence South 03°43'36" East 309.03 feet, more or less, to the approximate highwater mark of Beaver Lake; thence along said approximate highwater mark the following three courses: North 53°49'02" West 64.82 feet, North 74°27'53" West 46.24 feet and North 63°23'46" West 32.53 feet; thence North 01°17'11" West 413.93 feet, more or less to the beginning of a 145.00 foot radius non-tangent curve concave southwesterly having a radial bearing of South 32°52'18" West; thence along said curve through a central angle of 45°32'09" an arc length of 115.24 feet to the beginning of a 125.00 foot radius reverse curve; thence along said curve through a central angle of 44°00'12" an arc length of 96.00 feet to the Point of Beginning containing 0.955 acres of land, more or less, as shown on this Certificate of Survey which is herewith incorporated in and made a part of this legal description.

Lot 15

That portion of Government Lot 3, Section 20, Township 31 North, Range 22 West, Principal Meridian, Flathead County, Montana described as follows:

BEGINNING at a point that bears North 37°09'16" West 4735.99 feet from the Southeast Corner of Section 20, Township 31 North, Range 22 West, said point being on a 630.00 foot radius curve concave northeasterly having a radial bearing of North 35°44'50" East; thence along said curve through a central angle of 02°45'02" an arc length of 30.24 feet; thence South 57°00'12" East 112.78 feet; thence South 01°17'11" East 413.93 feet, more or less, to the approximate highwater mark of Beaver Lake; thence along said approximate highwater mark the following five courses: North 63°23'46" West 23.32 feet, North 78°39'42" West 33.41 feet, South 45°36'36" West 45.18 feet, South 02°17'45" East 57.59 feet, and South 47°39'23" West 34.60 feet; thence North 01°55'06" West 588.08 feet, more or less, to the Point of Beginning containing 1.230 acres of land, more or less, as shown on this Certificate of Survey which is herewith incorporated in and made a part of this legal description.

Lot 16

That portion of Government Lot 3, Section 20, Township 31 North, Range 22 West, Principal Meridian, Flathead County, Montana described as follows:

BEGINNING at a point that bears North 37°09'16" West 4735.99 feet from the Southeast Corner of Section 20, Township 31 North, Range 22 West; thence South 01°55'06" East 588.08 feet, more or less, to the approximate highwater mark of Beaver Lake; thence along said approximate highwater mark the following five courses: South 83°22'12" West 55.82 feet, North 38°24'18" West 34.92 feet, North 16°02'33" West 49.97 feet, North 20°24'07" West 51.45 feet, and North 80°58'41" West 11.21 feet; thence North 01°59'57" West 567.88 feet, more or less; thence South 49°54'52" East 107.78 feet to the beginning of a 630.00 foot radius curve to the left; thence along said curve through a central angle of 04°20'18" an arc length of 47.70 feet to the Point of Beginning containing 1.621 acres of land, more or less, as shown on this Certificate of Survey which is herewith incorporated in and made a part of this legal description.

LEGEND

- Found 1 1/4" outside diameter, galvanized, steel pipe, no cap, unless otherwise noted
- Found 5/8" diameter rebar, with 2" diameter aluminum cap marked, "EBY & ASSOCIATES" and "M.J. DRENTH 10684LS"
- Set 5/8" diameter rebar, 24" long, with 2" diameter aluminum cap marked, "EBY & ASSOCIATES" and "M.J. DRENTH 10684LS"

(Rec 1) or (R1) Record measurement per Certificate of Survey No. 18353

(Rec 2) Record measurement per Certificate of Survey No. 20364

COS# 22282

202200021449 Fees: \$26.50 by: JW
by Eby & Associates Inc
Date 8/15/2022 Time 12:36 PM
Debbie Pierson, Flathead County Montana

Page 2 of 2

Certificate of Survey No. 22282

